



Full Line Catalogue

Tracheostomy Products



Laryngectomy Products



Cuff Pressure Management



Accessories



Information

TRACOE®



Group Dynamics

Six decades of competence in tracheostomy products – and in the last 10 years more innovations than any other producer serving this market. 2010 TRACOE medical received the TOP 100 award to be one of the 100 most innovative middle-sized companies in Germany.

.....

COMPETENCE IN TRACHEOSTOMY

Over Six Decades of Expertise

TRACOE medical is your competent partner in the highly specialised field of tracheostomy and laryngectomy – for both physicians and patients.

Special requirements call for special solutions, which is why TRACOE medical offers a complete product line consisting of various product families which complement one another. They start with percutaneous sets for performing dilation tracheostomy, include an assortment of tracheostomy tubes, and extend to items for rehabilitation and aftercare. TRACOE medical also offers products to support proper functioning of the tubes, mainly for use in hospitals, rehab clinics and nursing homes. Tracheostomy accessories, made to harmonise precisely with other TRACOE products, help hospitals and homecare facilities to keep their costs under control while supporting patients in using, cleaning and properly caring for their tracheostomy tubes.

All tracheostomy tubes are developed by TRACOE medical, as they have the know-how for innovations to form and then to be turned into practice-oriented products.

For its continuous success to improve and complement the product range through innovations, the firm was not only elected "Company of the Year 2010 in the County Mainz-Bingen in the Category Innovation" but also belongs to one of the TOP 100 most innovative middle-sized companies 2010.

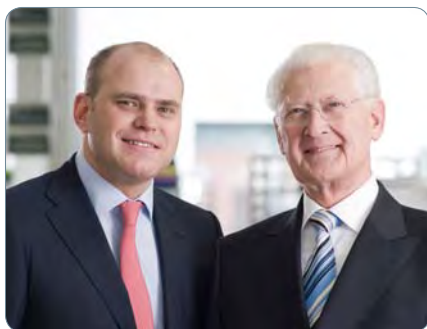

Certified Quality

TRACOE medical's products are CE-certified. This documents the fact that they are developed, manufactured and tested in compliance with legal requirements and the basic stipulations of the EC Directive on Medical Products 93/42/EEC (Annex 1). This certification is regularly renewed on the basis of audits by a Notified Body. QM certification has also been obtained to show that TRACOE medical has implemented an effective quality management system which conforms to DIN EN ISO 13485:2003, AC 2007. All of TRACOE medical's staff are integrated in this quality system to ensure a consistently high level of quality for all TRACOE products.

TRACOE products meet the requirements of the most demanding applications and comply with all relevant national and international guidelines and standards. They are registered and approved in many countries world-wide, including the United States (US21CFR820-FDA) and Canada (CanMDR).

Management

Successfull partners since 1992:
Prof. Dr. med. Franz Waldeck
(Development and Production),
Stephan Köhler (Administration,
Marketing and Sales).



NEW PRODUCT GROUP!

Ten Families of Products

Ten families of tracheostomy tubes and related products such as percutaneous dilation tracheostomy sets, precision instruments and accessories.

THE TRACOE PROGRAMME

From Hospitals to the Care of Permanent Wearers

TRACOE *percutan* experec

Sets for percutaneous tracheostomy Page 2

TRACOE *twist* Tracheostomy Tubes

Made of tissue-friendly polyurethane; for use in hospitals and during rehabilitation Page 20

TRACOE *vario* Tracheostomy Tubes

With variably adjustable neck flange – for use in hospitals Page 32

TRACOE *pure* Tracheostomy Tube

The economical version for short-term use Page 38

TRACOE *mini* Tracheostomy Tubes

Designed to meet the special requirements of neonates and children Page 40



TRACOE *comfort* Tracheostomy Tubes

Made of medical grade, clear polymer material – e.g. speaking tubes for long-term use in therapy, during rehabilitation and for permanent wearers Page 44

TRACOE *modular*

Speaking valves as well as heat/moisture exchangers – for attachment to tracheostomy tubes, stoma buttons, short tubes and adhesive carriers Page 56

TRACOE *technic* Medical Technology

Precision medical instruments for the cuff pressure management Page 64

TRACOE *larynx*

stoma buttons, silicone short tubes, adhesive carriers and button plus Page 68

TRACOE *care* Accessories

For ongoing care as well as product maintenance and cleaning Page 74

Information for Patients

Useful information about TRACOE tubes and daily care of them Page 86

Information for Distributors

Information for hospitals and distributors. Contact information, how to place orders, sales support, etc. Page 88



Intensive Care

Complete sets for percutaneous dilation tracheostomy. Feature: The atraumatic inserter and the atraumatic insertion system – a soft silicone sleeve smoothes the gap between inserter and tube.



TRACOE®

percutan

A Proven Technique

Percutaneous dilation tracheostomy has established itself as a standard procedure in intensive medicine. The Ciaglia technique is the one most widely used. The TRACOE experc system is based on this proven method, so there is no need to learn a new procedure. The sets are tailored to the use of unfenestrated and fenestrated tubes as well as tubes with subglottic suction line of the product groups TRACOE *twist*, incl. TRACOE *twist plus* **NEW!**, and TRACOE *vario* (not fenestrated).

The Feature

How to slide the tube over the insertion instrument into the tracheostoma is a challenge in percutaneous dilation tracheostomy. The TRACOE experc sets deliver the solution in form of the patented atraumatic inserter and the atraumatic insertion system. A soft silicone sleeve at the tip of the insertion instruments smoothly bridges the gap in diameter between the inserter and the tube. This lets the tube be inserted safely and easily.

Option for Reinsertion

For difficult reinsertion situations unfenestrated and fenestrated TRACOE *twist*, *twist plus* **NEW!** as well as unfenestrated TRACOE *vario* tubes are available. They are available individually and premounted on the atraumatic inserter. The offered Seldinger guide wire should be used in any difficult case.



REF 320

REF 321

REF 322

TRACOE experc Set *twist*

REF 320 Set in sterile package

- ◆ 1 TRACOE experc Dilation Set (REF 520)
- ◆ 1 TRACOE *twist* tracheostomy tube with low pressure cuff and atraumatic inserter (REF 301-P)

REF 321 Set in sterile package

- ◆ 1 TRACOE experc Dilation Set (REF 520)
- ◆ 1 TRACOE *twist* tracheostomy tube, fenestrated, with low pressure cuff and atraumatic inserter (REF 302-P)

REF 322 Set in sterile package

- ◆ 1 TRACOE experc Dilation Set (REF 520)
- ◆ 1 TRACOE *twist* tracheostomy tube with low pressure cuff, subglottic suction line and atraumatic inserter (REF 306-P)

i REF 322: As a product variant the set is also available with REF 888-306-P, fenestrated

i TRACOE *twist* tubes REF 301-P, REF 302-P and REF 306-P as well as TRACOE experc Dilation Set (REF 520) are also available separately.

Package Contents per Set:

TRACOE experc Dilation Set for Percutaneous Tracheostomy, in sterile Package

REF 520

- ◆ Scalpel
- ◆ Syringe
- ◆ Puncture needle (14 G) with Teflon catheter
- ◆ Seldinger guide wire made of kink resistant NiTiNol with inserter
- ◆ Short dilator 14 CH/FR
- ◆ Guiding catheter with safety stop
- ◆ TRACOE experc dilator with hydrophilic coating (slides easily after moistening)
- ◆ 4 compresses



TRACOE *twist* Tracheostomy Tube with Low Pressure Cuff and Atraumatic Inserter, in sterile Package:

REF 301-P unfenestrated (see Page 6),
or REF 302-P fenestrated (see Page 6),
or REF 306-P unfenestrated, with subglottic suction line (see Page 7)

Fig. 1



Fig. 2

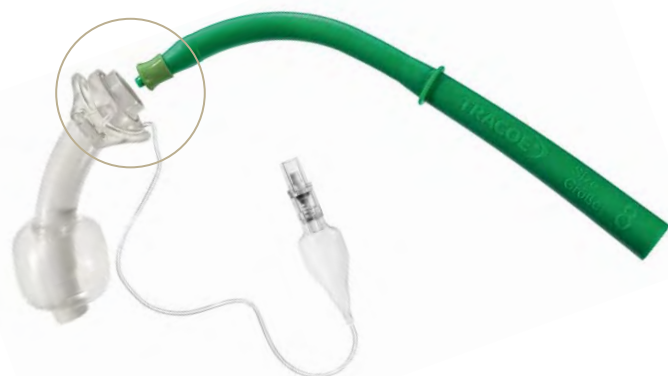

The Feature of the TRACOE expirc Set *twist* is the Atraumatic Insertion System of the Tubes.

Its tip has a folding silicone sleeve that smoothly bridges over the gap in diameter between the inserter and the end of the tube (Fig. 1).

The inserter also excels with a precise fit into the tube and a stop at the 15mm connector. Once the tube is in the trachea, the inserter is pulled out of the tube. In doing so the silicone sleeve flaps back to facilitate its easy removal (Fig. 2).

The Benefits:

- ◆ Dilation is performed using the Ciaglia one-step technique.
- ◆ The atraumatic inserter smoothes over the gap in diameter between the end of the tube and the inserter. This minimizes the risk of injury when inserting the tracheostomy tube into the trachea.
- ◆ The stop at the 15mm connector prevents the inserter from being inserted too far into the tube, which additionally reduces the risk of injury.
- ◆ The separately available tubes with insertion system can also be used for reinsertion into a percutaneously created tracheostoma and/or change tubes; if necessary in combination with the Seldinger guide wire (see page 19).

| Ordering Information: REF 320, REF 321 and REF 322 | Size | REF-No. | Units/package |
|--|------|------------|---------------|
| REF 320, consisting of: 1 TRACOE expirc Dilation Set (REF 520) and 1 TRACOE <i>twist</i> tracheostomy tube, <u>unfenestrated</u> , with low pressure cuff and atraumatic inserter (REF 301-P) | 07 | REF 320-07 | 1 |
| | 08 | REF 320-08 | 1 |
| | 09 | REF 320-09 | 1 |
| REF 321, consisting of: 1 TRACOE expirc Dilation Set (REF 520) and 1 TRACOE <i>twist</i> tracheostomy tube, <u>fenestrated</u> , with low pressure cuff and atraumatic inserter (REF 302-P) | 07 | REF 321-07 | 1 |
| | 08 | REF 321-08 | 1 |
| | 09 | REF 321-09 | 1 |
| REF 322, consisting of: 1 TRACOE expirc Dilation Set (REF 520) and 1 TRACOE <i>twist</i> tracheostomy tube, <u>unfenestrated</u> , <u>with subglottic suction line</u> , low pressure cuff and atraumatic inserter (REF 306-P) | 07 | REF 322-07 | 1 |
| | 08 | REF 322-08 | 1 |
| | 09 | REF 322-09 | 1 |



REF 301-P

**TRACOE twist Tracheostomy Tube,
Unfenestrated, with Low Pressure Cuff
and Atraumatic Insertter**

REF 301-P In sterile package

- ◆ Outer cannula with cuff
- ◆ 2 inner cannulas with 15 mm connector
- ◆ Atraumatic inserter
- ◆ Reinsertion tube
- ◆ Sterile lubricating gel
- ◆ Perforated Obturator and wide neck strap (shown below)



REF 302-P

**TRACOE twist Tracheostomy Tube,
Fenestrated, with Low Pressure Cuff
and Atraumatic Insertter**

REF 302-P In sterile package

- ◆ Outer cannula, fenestrated, with cuff
- ◆ Inner cannula with 15 mm connector
- ◆ Inner cannula, fenestrated, with 15 mm connector
- ◆ Occlusion cap
- ◆ Atraumatic inserter
- ◆ Reinsertion tube
- ◆ Sterile lubricating gel
- ◆ Perforated obturator and wide neck strap (shown below)

i Each TRACOE *twist* tube is supplied with a perforated obturator and a wide adjustable neck strap as well as a tube info card with peel-off stickers on front and back. The neck strap is also available separately (REF 903-F).

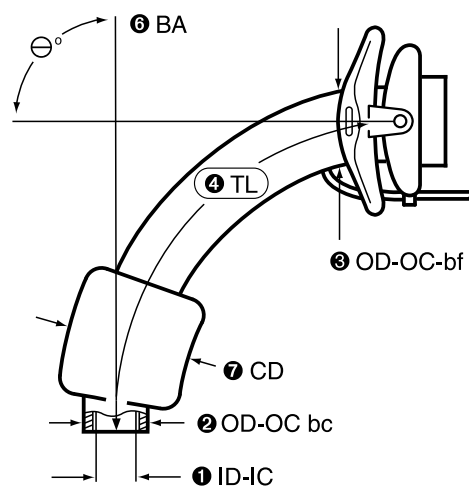



REF 306-P



REF 888-306-P

**TRACOE twist Tracheostomy Tube,
Unfenestrated, with Low Pressure Cuff,
Subglottic Suction Line and Atraumatic Inserter**

REF 306-P *In sterile package*

- ◆ Outer cannula with cuff and subglottic suction line
- ◆ 2 inner cannulas with 15 mm connector
- ◆ 2 connectors for suction devices
- ◆ Atraumatic inserter
- ◆ Reinsertion tube
- ◆ Sterile lubricating gel
- ◆ Perforated obturator and wide neck strap (shown on page 6)

Product Variant:

**TRACOE twist Tracheostomy Tube,
Fenestrated, with Low Pressure Cuff,
Subglottic Suction Line and Atraumatic Inserter**

REF 888-306-P *In sterile package*

- ◆ Outer cannula, fenestrated, with cuff and subglottic suction line
- ◆ Inner cannula with 15 mm connector
- ◆ Inner cannula, fenestrated, with 15 mm connector
- ◆ 2 connectors for suction devices
- ◆ Atraumatic inserter
- ◆ Reinsertion tube
- ◆ Sterile lubricating gel
- ◆ Perforated obturator and wide neck strap (shown on page 6)

Reference Numbers and Measurements: REF 301-P, REF 302-P and REF 306-P

| Size | ❶ ID-IC (mm) | ❷ OD-OC bc (mm) | ❸ OD-OC bf (mm) | Lengths (mm) | | ❹ BA (°) | ❺ CD (mm) |
|------|-----------------|--------------------|--------------------|--------------|------|-------------|--------------|
| | | | | ❹ TL | ❺ AB | | |
| 07 | 7.0 | 10.4 | 12.0 | 74 | 80.5 | 95 | 26 |
| 08 | 8.0 | 11.4 | 12.7 | 76 | 83.0 | 90 | 28 |
| 09 | 9.0 | 12.5 | 14.2 | 78 | 88.5 | 90 | 30 |

❶ ID-IC: inside diameter (clear width) at bottom of inner cannula; ❷ OD-OC bc: outside diameter at bottom of outer cannula; ❸ OD-OC bf: outside diameter of outer cannula behind the flange; ❹ Length TL: along centre line from start of neck flange to bottom of tube; ❺ Length AB: length along outer bend from start of neck flange to bottom of tube; ❹ BA: bending angle; ❺ CD: cuff diameter

► To order, specify: REF + size (e.g. REF 301-07-P).



TRACOE expirc Set *twist plus*

up to Size 10



REF 330

NEW!

REF 331

NEW!

REF 332

NEW!

TRACOE expirc Set *twist plus*

i Also available in size 10!

REF 330 *Set in sterile package*

- ◆ 1 TRACOE expirc Dilation Set (REF 520)
- ◆ 1 TRACOE *twist plus* tracheostomy tube with low pressure cuff and atraumatic insertion system (REF 311-P)

REF 331 *Set in sterile package*

- ◆ 1 TRACOE expirc Dilation Set (REF 520)
- ◆ 1 TRACOE *twist plus* tracheostomy tube double fenestrated, with low pressure cuff and atraumatic insertion system (REF 312-P)

REF 332 *Set in sterile package*

- ◆ 1 TRACOE expirc Dilation Set (REF 520)
- ◆ 1 TRACOE *twist plus* tracheostomy tube, unfenestrated, with low pressure cuff, with subglottic suction line and atraumatic insertion system (REF 316-P)

i REF 332: As a product variant the set is also available with REF 888-316-P, fenestrated

i TRACOE *twist plus* tubes REF 311-P, REF 312-P and REF 316-P as well as TRACOE expirc Dilation Set (REF 520) are also available separately.

Package Contents per Set:

TRACOE expirc Dilation Set for Percutaneous Tracheostomy, in sterile Package

REF 520

- ◆ Scalpel
- ◆ Syringe
- ◆ Puncture needle (14 G) with Teflon catheter
- ◆ Seldinger guide wire made of kink resistant NiTiNol with inserter
- ◆ Short dilator 14 CH/FR
- ◆ Guiding catheter with safety stop
- ◆ TRACOE expirc dilator with hydrophilic coating (slides easily after moistening)
- ◆ 4 compresses



TRACOE *twist plus* Tracheostomy Tube with Low Pressure Cuff and Atraumatic Inserter, in sterile Package:

REF 311-P *unfenestrated* (page 10),
or REF 312-P *double fenestrated* (page 10),
or REF 316-P *unfenestrated, with subglottic suction line* (page 11)

Fig. 1



Fig. 2

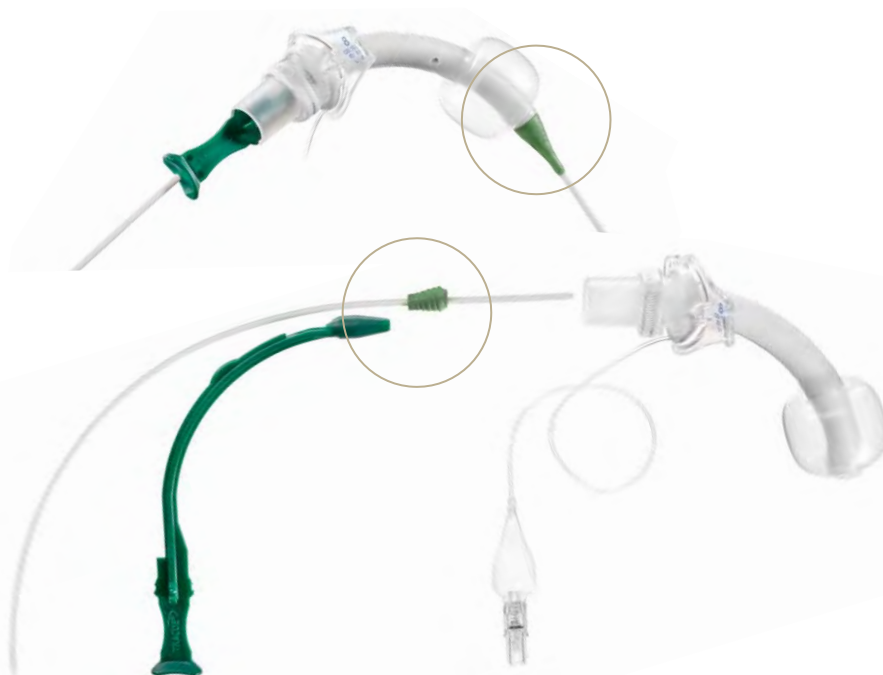
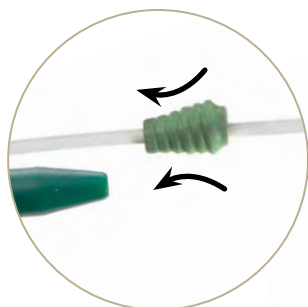

The Feature of the TRACOE expirc Sets *twist plus* is the Atraumatic Insertion System of the Tubes.

The system consists of two parts: the white guiding catheter with silicone sleeve and the green inserter in the inner cannula. The silicone sleeve smoothly bridges over the gap in diameter between the end of the tube and the inserter thus minimising the risk of injury when inserting the tracheostomy tube into the trachea (see Fig. 1).

The TRACOE *twist plus* tracheostomy tubes are delivered pre-mounted on the atraumatic insertion system, the inner cannula is already placed in the tube. The insertion system stabilises and assists guiding the tube; it excels with a precise fit into the tube and a stop at the 15 mm connector.

Once the tube is in the trachea the green inserter and the white guiding catheter with silicone sleeve are grabbed as a unit and removed together. By doing so the silicone sleeve flaps back and the guiding catheter can be removed easily (see Fig. 2). The Seldinger guide wire can be removed either prior or together with the guiding catheter. Alternatively the

green inserter can be removed first, followed by the white guiding catheter and the Seldinger guide wire. Under no circumstances the white guiding catheter must be removed first.

The Benefits:

- ◆ Dilation is performed using the proven Ciaglia one-step technique.
- ◆ The atraumatic inserter smoothes over the gap in diameter between the end of the tube and the inserter. This minimises the risk of injury when inserting the tracheostomy tube into the trachea.
- ◆ The stop at the 15 mm connector prevents the inserter from being inserted too far into the tube, which additionally reduces the risk of injury.
- ◆ The separately available tubes with inserting system can also be used for reinsertion into a percutaneously created tracheostoma and/or change tubes; if necessary in combination with the Seldinger guide wire (see page 19).

| Ordering Information: REF 330, REF 331 and REF 332 | Size | REF-No. | Units/package |
|---|------|------------|---------------|
| REF 330, consisting of: 1 TRACOE expirc Dilation Set (REF 520) and 1 TRACOE <i>twist</i> plus tracheostomy tube, <u>unfenestrated</u> , with low pressure cuff and atraumatic insertion system (REF 311-P) | 07 | REF 330-07 | 1 |
| | 08 | REF 330-08 | 1 |
| | 09 | REF 330-09 | 1 |
| | 10 | REF 330-10 | 1 |
| REF 331, consisting of: 1 TRACOE expirc Dilation Set (REF 520) and 1 TRACOE <i>twist</i> plus tracheostomy tube, <u>double fenestrated</u> , with low pressure cuff and atraumatic insertion system (REF 312-P) | 07 | REF 331-07 | 1 |
| | 08 | REF 331-08 | 1 |
| | 09 | REF 331-09 | 1 |
| | 10 | REF 331-10 | 1 |
| REF 332, consisting of: 1 TRACOE expirc Dilation Set (REF 520) and 1 TRACOE <i>twist</i> plus tracheostomy tube, <u>unfenestrated</u> , with <u>subglottic suction line</u> , low pressure cuff and atraumatic insertion system (REF 316-P) | 07 | REF 332-07 | 1 |
| | 08 | REF 332-08 | 1 |
| | 09 | REF 332-09 | 1 |
| | 10 | REF 332-10 | 1 |



REF 311-P

NEW!

TRACOE *twist plus* Tracheostomy Tube, Unfenestrated, with Low Pressure Cuff and Atraumatic Insertion System

REF 311-P In sterile package

- ◆ Outer cannula with cuff
- ◆ 2 inner cannulas with 15 mm connector
- ◆ Atraumatic insertion system
- ◆ Sterile lubricating gel
- ◆ Perforated Obturator and wide neck strap (shown below)



Detail of the additional fenestration at the inner bend

REF 312-P

NEW!



TRACOE *twist plus* Tracheostomy Tube, Double Fenestrated, with Low Pressure Cuff and Atraumatic Insertion System

REF 312-P In sterile package

- ◆ Outer cannula, double fenestrated, with cuff
- ◆ Inner cannula with 15 mm connector
- ◆ Inner cannula, double fenestrated with 15 mm connector
- ◆ Occlusion cap
- ◆ Atraumatic insertion system
- ◆ Sterile lubricating gel
- ◆ Perforated obturator and wide neck strap (shown below)

twist plus

i Features of TRACOE *twist plus* tubes are shown on page 28.

i Each TRACOE *twist plus* tube is supplied with a perforated obturator and a wide adjustable neck strap as well as a tube info card with peel-off stickers on front and back. The neck strap is also available separately (REF 903-F).

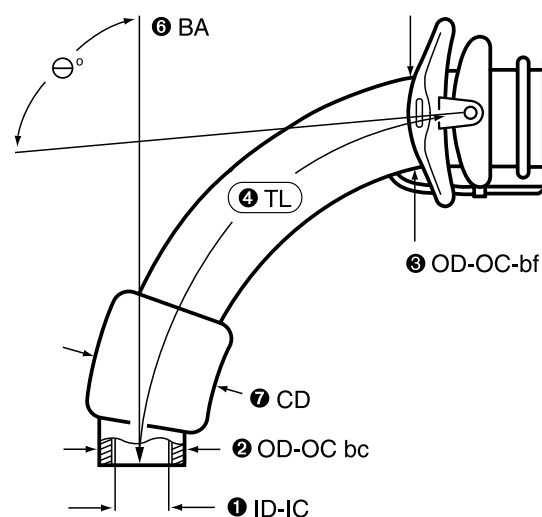



REF 316-P

NEW!



Detail of the additional fenestration
at the inner bend

REF 888-316-P

NEW!



TRACOE *twist plus* Tracheostomy Tube, Unfenestrated, with Low Pressure Cuff, Subglottic Suction Line and Atraumatic Insertion System

REF 316-P

In sterile package

- ◆ Outer cannula with cuff and subglottic suction line
- ◆ 2 inner cannulas with 15 mm connector
- ◆ 2 connectors for suction devices
- ◆ Atraumatic insertion system
- ◆ Sterile lubricating gel
- ◆ Perforated obturator and wide neck strap (shown on page 10)

Product Variant :

TRACOE *twist plus* Tracheostomy Tube, Double Fenestrated, with Low Pressure Cuff, Subglottic Suction Line and Atraumatic Insertion System

REF 888-316-P

In sterile package

- ◆ Outer cannula, double fenestrated, with cuff and subglottic suction line
- ◆ Inner cannula with 15 mm connector
- ◆ Inner cannula, double fenestrated, with 15 mm connector
- ◆ 2 connectors for suction devices
- ◆ Atraumatic insertion system
- ◆ Sterile lubricating gel
- ◆ Perforated obturator and wide neck strap (shown on page 10)

Reference Numbers and Measurements: REF 311-P, REF 312-P and REF 316-P

| Size | ❶ ID-IC (mm) | ❷ OD-OC bc (mm) | ❸ OD-OC bf (mm) | Lengths (mm) | | ❹ BA (°) | ❺ CD (mm) |
|------|--------------|-----------------|-----------------|--------------|------|----------|-----------|
| | | | | ❹ TL | ❺ AB | | |
| 07 | 7.0 | 9.8 | 10.1 | 85 | 91 | 100 | 26 |
| 08 | 8.0 | 10.8 | 11.1 | 88 | 95 | 100 | 28 |
| 09 | 9.0 | 11.8 | 12.1 | 90 | 99 | 100 | 30 |
| 10 | 10.0 | 12.8 | 13.1 | 92 | 102 | 100 | 32 |

❶ ID-IC: inside diameter (clear width) at bottom of inner cannula; ❷ OD-OC bc: outside diameter at bottom of outer cannula; ❸ OD-OC bf: outside diameter of outer cannula behind the flange; ❹ Length TL: along centre line from start of neck flange to bottom of tube; ❺ Length AB: length along outer bend from start of neck flange to bottom of tube; ❹ BA: bending angle; ❺ CD: cuff diameter

► To order, specify: REF + size (e.g. REF 311-07-P)





REF 420

REF 421

REF 422

NEW!

REF 423

TRACOE expirc Set vario

REF 420 *Set in sterile package*

- ◆ 1 TRACOE expirc Dilation Set (REF 520)
- ◆ 1 TRACOE vario tracheostomy tube, spiral-reinforced, with adjustable neck flange, low pressure cuff and atraumatic insertion system (REF 450-P)

REF 421 *Set in sterile package*

- ◆ 1 TRACOE expirc Dilation Set (REF 520)
- ◆ 1 TRACOE vario **XL** tracheostomy tube, spiral-reinforced, with adjustable neck flange, low pressure cuff and atraumatic insertion system (REF 451-P)

REF 422 *Set in sterile package*

- ◆ 1 TRACOE expirc Dilation Set (REF 520)
- ◆ 1 TRACOE vario extract tracheostomy tube with adjustable neck flange, low pressure cuff, subglottic suction line and atraumatic insertion system (REF 470-P)

REF 423 *Set in sterile package*

- ◆ 1 TRACOE expirc Dilation Set (REF 520)
- ◆ 1 TRACOE vario tracheostomy tube with adjustable neck flange, low pressure cuff and atraumatic insertion system (REF 460-P)

Package Contents per Set:

TRACOE expirc Dilation Set for Percutaneous Tracheostomy, in sterile Package

REF 520

- ◆ Scalpel
- ◆ Syringe
- ◆ Puncture needle (14 G) with Teflon catheter
- ◆ Seldinger guide wire made of kink resistant NiTiNoI with inserter
- ◆ Short dilator 14 CH/FR
- ◆ Guiding catheter with safety stop
- ◆ TRACOE expirc dilator with hydrophilic coating (slides easily after moistening)
- ◆ 4 compresses



TRACOE vario Tracheostomy Tube with Adjustable Neck Flange, Low Pressure Cuff and Atraumatic Insertion System, in sterile Package:

- REF 450-P** *spiral-reinforced (see Page 15),*
- or **REF 451-P** *extra-long, spiral-reinforced (see Page 15),*
- or **REF 460-P** *not spiral-reinforced (see Page 16),*
- or **REF 461-P** *extra-long, not spiral-reinforced (see Page 16),*
- or **REF 470-P** *not spiral-reinforced, with subglottic suction line (see Page 17),*
- or **REF 471-P** *extra-long, not spiral-reinforced, with subglottic suction line (see Page 17)*



TRACOE vario tubes REF 450-P, REF 451-P, REF 460-P, REF 461-P, REF 470-P and REF 471-P as well as TRACOE expirc Dilation Set (REF 520) are also available separately.



The optimized TRACOE vario tubes have an adjustable neck flange with locking lever and pliable wings on the flange that can be adjusted independently of one another

REF 424

NEW!

REF 425

NEW!

REF 424

Set in sterile package

- ◆ 1 TRACOE expirc Dilation Set (REF 520)
- ◆ 1 TRACOE vario **XL** tracheostomy tube with adjustable neck flange, low pressure cuff and atraumatic insertion system (REF 461-P)

REF 425

Set in sterile package

- ◆ 1 TRACOE expirc Dilation Set (REF 520)
- ◆ 1 TRACOE vario extract **XL** tracheostomy tube with adjustable neck flange, low pressure cuff, subglottic suction line and atraumatic insertion system (REF 471-P)

Ordering Information:

REF 420, REF 421, REF 422, REF 423, REF 424 and REF 425

| | Size | REF-No | Units/package |
|---|------|------------|---------------|
| REF 420 consisting of: 1 TRACOE expirc Dilation Set (REF 520) and 1 TRACOE vario tracheostomy tube with adjustable neck flange, spiral-reinforced, with low pressure cuff and atraumatic insertion system (REF 450-P) | 07 | REF 420-07 | 1 |
| | 08 | REF 420-08 | 1 |
| | 09 | REF 420-09 | 1 |
| REF 421 consisting of: 1 TRACOE expirc Dilation Set (REF 520) and 1 TRACOE vario XL tracheostomy tube with adjustable neck flange, spiral-reinforced, with low pressure cuff and atraumatic insertion system (REF 451-P) | 07 | REF 421-07 | 1 |
| | 08 | REF 421-08 | 1 |
| | 09 | REF 421-09 | 1 |
| REF 422, consisting of: 1 TRACOE expirc Dilation Set (REF 520) and 1 TRACOE vario extract tracheostomy tube with adjustable neck flange, low pressure cuff, <u>subglottic suction line</u> and atraumatic insertion system (REF 470-P) | 08 | REF 422-08 | 1 |
| | 09 | REF 422-09 | 1 |
| REF 423, consisting of: 1 TRACOE expirc Dilation Set (REF 520) and 1 TRACOE vario tracheostomy tube with adjustable neck flange, low pressure cuff and atraumatic insertion system (REF 460-P) | 07 | REF 423-07 | 1 |
| | 08 | REF 423-08 | 1 |
| | 09 | REF 423-09 | 1 |
| REF 424, consisting of: 1 TRACOE expirc Dilation Set (REF 520) and 1 TRACOE vario XL tracheostomy tube with adjustable neck flange, low pressure cuff and atraumatic insertion system (REF 461-P) | 07 | REF 424-07 | 1 |
| | 08 | REF 424-08 | 1 |
| | 09 | REF 424-09 | 1 |
| REF 425, consisting of: 1 TRACOE expirc Dilation Set (REF 520) and 1 TRACOE vario extract XL tracheostomy tube with adjustable neck flange, low pressure cuff, <u>subglottic suction line</u> and atraumatic insertion system (REF 471-P) | 08 | REF 425-08 | 1 |
| | 09 | REF 425-09 | 1 |

Fig. 1



Fig. 2



The Feature of the TRACOE expirc Set vario is the Atraumatic Insertion System of the Tubes.

The system consists of two parts: the guiding catheter with silicone sleeve and the inserter for stabilisation and guidance of the tube.

The silicone sleeve smoothly bridges over the gap in diameter between the end of the tube and the inserter thus minimising the risk of injury when inserting the tracheostomy tube into the trachea (see Fig. 1).

The insertion system excels with a precise fit into the tube and a stop at the 15mm connector. Once the tube is in the trachea first the inserter is removed and only then the guiding catheter with silicone sleeve. By doing so the silicone sleeve flaps back and the guiding catheter can be removed easily (see Fig. 2). The Seldinger guide wire can be removed either prior or together with the guiding catheter. Under no circumstances the guiding catheter must be removed first.

The Benefits:

- ◆ Dilation is performed using the proven Ciaglia one-step-technique.
- ◆ The atraumatic insertion system smoothes over the gap in diameter between the end of the tube and the inserter. This minimises the risk of injury when inserting the tracheostomy tube into the trachea.
- ◆ The stop at the 15mm connector prevents the inserter from being inserted too far into the tube, which additionally reduces the risk of injury.
- ◆ The separately available tubes with insertion system can also be used for reinsertion into a percutaneously created tracheostoma and/or change tubes; if necessary in combination with the Seldinger guide wire (see page 19).



REF 450-P

TRACOE vario Tracheostomy Tube
Spiral-Reinforced, with Adjustable Neck Flange,
Low Pressure Cuff and Atraumatic Insertion
System

REF 450-P

In sterile package

- ◆ Cannula with 15 mm connector, spiral-reinforced, with cuff, scale and atraumatic insertion system
- ◆ Sterile lubricating gel
- ◆ Obturator and wide neck strap (shown below)



REF 451-P

NEW!

TRACOE vario XL Tracheostomy Tube,
Extra-Long, Spiral-Reinforced, with Adjustable
Neck Flange, Low Pressure Cuff and Atraumatic
Insertion System

REF 451-P

In sterile package

- ◆ Cannula, extra-long, with 15 mm connector, spiral-reinforced, with cuff, scale and atraumatic insertion system
- ◆ Sterile lubricating gel
- ◆ Obturator and wide neck strap (shown below)



Each TRACOE vario tube is supplied with an

obturator and a wide adjustable neck strap as well as a tube info card with peel-off stickers on front and back. The neck strap is also available separately (REF 903-F).





REF 460-P

**TRACOE vario Tracheostomy Tube
with Adjustable Neck Flange, Low Pressure Cuff
and Atraumatic Insertion System**

REF 460-P *In sterile package*

- ◆ Cannula with 15 mm connector, cuff, X-ray contrast line, scale and atraumatic insertion system
- ◆ Sterile lubricating gel
- ◆ Obturator and wide neck strap (shown on page 15)



REF 461-P

NEW!

**TRACOE vario XL Tracheostomy Tube,
Extra-Long, with Adjustable Neck Flange, Low
Pressure Cuff and Atraumatic Insertion System**

REF 461-P *In sterile package*

- ◆ Cannula, extra-long, with 15 mm connector, cuff, X-ray contrast line, scale and atraumatic insertion system
- ◆ Sterile lubricating gel
- ◆ Obturator and wide neck strap (shown on page 15)

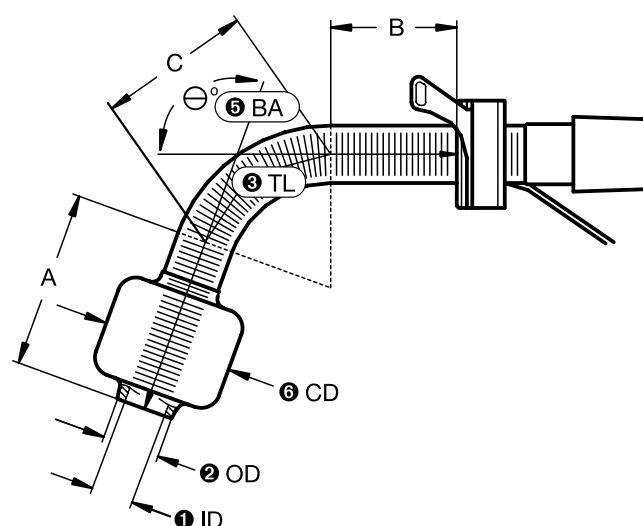



REF 470-P

TRACOE vario extract Tracheostomy Tube with Adjustable Neck Flange, Low Pressure Cuff, Subglottic Suction Line and Atraumatic Insertion System

REF 470-P In sterile package

- ◆ Cannula with 15 mm connector, cuff, X-ray contrast line, scale, subglottic suction line and atraumatic insertion system
- ◆ 2 connectors for suction devices
- ◆ Sterile lubricating gel
- ◆ Obturator and wide neck strap (shown on page 15)



REF 471-P

NEW!

TRACOE vario extract XL Tracheostomy Tube, Extra-Long, with Adjustable Neck Flange, Low Pressure Cuff, Subglottic Suction Line and Atraumatic Insertion System

REF 471-P In sterile package

- ◆ Cannula, extra-long, with 15 mm connector, cuff, X-ray contrast line, scale, subglottic suction line and atraumatic insertion system
- ◆ 2 connectors for suction devices
- ◆ Sterile lubricating gel
- ◆ Obturator and wide neck strap (shown on page 15)

Reference Numbers and Measurements: REF 450-P, REF 460-P and REF 470-P (not available in size 07)

| Size | ❶ ID (mm) | ❷ OD (mm) | Lengths (mm) | | | | | ❸ BA (°) | ❹ CD (mm) |
|------|-----------|-----------|--------------|----|----|------|------|----------|-----------|
| | | | A | C | B | ❸ TL | ❹ AB | | |
| 07 | 7.0 | 9.7 | 33 | 32 | 15 | 80 | 86 | 100 | 26 |
| 08 | 8.0 | 11.2 | 35 | 35 | 20 | 90 | 97 | 100 | 28 |
| 09 | 9.0 | 12.3 | 38 | 35 | 27 | 100 | 106 | 100 | 30 |

Reference Numbers and Measurements: REF 451-P, REF 461-P and REF 471-P (not available in size 07)

| | | | | | | | | | |
|----|-----|------|----|----|----|-----|-----|-----|----|
| 07 | 7.0 | 9.7 | 35 | 36 | 33 | 104 | 110 | 100 | 26 |
| 08 | 8.0 | 11.2 | 37 | 46 | 40 | 123 | 128 | 100 | 28 |
| 09 | 9.0 | 12.3 | 38 | 46 | 42 | 126 | 134 | 100 | 30 |

❶ ID: inside diameter (clear width) at bottom of cannula; ❷ OD: outside diameter at bottom of cannula; ❸ TL: length along centre line; ❹ AB: length along outer bend; ❸ BA: bending angle; ❹ CD: cuff diameter

► To order, specify REF + size (e.g. REF 450-07-P).



REF 520

TRACOE expirc Dilation Set

In sterile package

The TRACOE expirc Dilation Set can be supplemented with the tracheostomy tube which is best suited for the patient:

For patients needing ventilation

- ▶ REF 450-P (page 15), as Set REF 420 (page 12)
- ▶ REF 451-P (page 15), as Set REF 421 (page 12)

For patients with thick neck

- ▶ REF 451-P (page 15), as Set REF 421 (page 12)
- ▶ REF 461-P (page 16), as Set REF 424 (page 13)
- ▶ REF 471-P (page 17), as Set REF 425 (page 13)

For ventilation

- ▶ REF 460-P (page 16), as Set REF 423 (page 12)
- ▶ REF 461-P (page 16), as Set REF 424 (page 13)

For ventilation and/or rehabilitation

- ▶ REF 301-P (page 6), as Set REF 320 (page 4)
- ▶ REF 311-P (page 10), as Set REF 330 (page 8)

For ventilation and/or rehabilitation – as speaking tube

- ▶ REF 302-P (page 6), as Set REF 321 (page 4)
- ▶ REF 312-P (page 10), as Set REF 331 (page 8)

For ventilation and/or rehabilitation – with subglottic suction line

- ▶ REF 306-P (page 11), as Set REF 322 (page 4)
- ▶ REF 316-P (page 11), as Set REF 332 (page 8)
- ▶ REF 470-P (page 17), as Set REF 422 (page 12)
- ▶ REF 471-P (page 17), as Set REF 425 (page 13)



REF 450-P
TRACOE *vario*, spiral-reinforced



REF 460-P
TRACOE *vario*, not spiral-reinforced



REF 451-P
TRACOE *vario*, extra-long, spiral-reinforced



REF 461-P
TRACOE *vario*, extra-long, not spiral-reinforced



REF 470-P
TRACOE *vario* extract, not spiral-reinforced, with subglottic suction line



REF 471-P
TRACOE *vario* extract, extra-long, not spiral-reinforced, with subglottic suction line



REF 301-P
TRACOE *twist*, not fenestrated



REF 302-P
TRACOE *twist*, fenestrated



REF 306-P
TRACOE *twist*, not fenestrated, with subglottic suction line



REF 311-P
TRACOE *twist* plus, not fenestrated



REF 312-P
TRACOE *twist* plus, double fenestrated



REF 316-P
TRACOE *twist* plus, not fenestrated, with subglottic suction line



All TRACOE tracheostomy tubes for the percutaneous tracheostomy are available in sizes 07, 08 and 09 (REF 470-P and REF 471-P only in sizes 08 and 09). TRACOE *twist* plus tracheostomy tubes are available in size 10 as well.

Accessories



REF 517



REF 518

Seldinger Guide Wire with Guiding Catheter

REF 517 *Set in sterile package*

- ◆ Seldinger guide wire made of kink resistant NiTiNoI
- ◆ Guiding catheter

To be used with all TRACOE *twist* tubes with atraumatic inserter.

Seldinger Guide Wire

REF 518 *Pack of 5, supplied in individual sterile packages*

- ◆ Seldinger guide wire made of kink resistant NiTiNoI



The Seldinger technic with the Seldinger Guide Wire, should be used in difficult situations to provide a safer guided way into the trachea.



Increased Flexibility

Originally developed for inpatient applications, but now also very often used during rehabilitation as therapy-tube and by patients at home.

Twelve tube models in various sizes, large range of replacement parts and accessories.

TRACOE[®]

twist

High Acceptance

TRACOE *twist* tubes are made of tissue-friendly medical-grade polyurethane, so that they are well-tolerated by patients. They are radiopaque and come in sterile packages.

Maximum Mobility

The most outstanding feature of TRACOE *twist* is the anatomically shaped neck flange that moves around two axes: vertically (a) and horizontally (b). This allows patients to turn their head and neck freely without the tube exerting pressure on the trachea. The neck strap can easily be attached while the tube is in situ (c). TRACOE *twist* tubes have thin walls, which ensure maximum air flow. The material of the low pressure cuff is soft and flexible and ensures a good sealing of the trachea with accurate cuff pressure management.

Maximum Cost-Effectiveness

TRACOE *twist* tubes were originally developed primarily for clinical use: e.g. for mechanical ventilation in intensive care or for ENT surgery. However, TRACOE *twist* tubes are now very often used during rehabilitation and by patients at home. The investment is enhanced by a broad range of replacement parts and accessories.

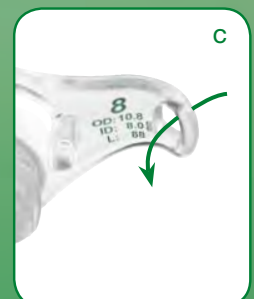

TRACOE *twist* – Tracheostomy Tubes



REF 301



Colour Coding



REF 302



Colour Coding



Tracheostomy Tube with Low Pressure Cuff

REF 301 *In sterile package*

- ◆ Outer cannula with cuff
- ◆ 2 inner cannulas with 15 mm connector
- ◆ Perforated obturator and wide neck strap (shown below)

i Neck flange, blue writing:
fenestrated outer cannula



i Neck flange, green writing:
unfenestrated outer cannula



i Each TRACOE *twist* tube is supplied with a perforated obturator and a wide adjustable neck strap as well as a tube info card with peel-off stickers on front and back. The neck strap is also available separately (REF 903-F).



Fenestrated Tracheostomy Tube with Low Pressure Cuff

REF 302 *In sterile package*

- ◆ Outer cannula, fenestrated, with cuff
- ◆ Inner cannula, fenestrated, with 15 mm connector
- ◆ Inner cannula with 15 mm connector
- ◆ Occlusion cap for 15 mm connector
- ◆ Perforated obturator and wide neck strap (shown below)

i **TRACOE *twist* Colour Coding:**

● REF 301 ● REF 302 ● REF 303 ● REF 304

● REF 305 ● REF 306 ● REF 309

The colour coding is conspicuously printed on each box. This helps you organise your inventory and quickly and reliably locate the right tube.

i **REF 301-P, REF 302-P and REF 306-P:**

TRACOE *twist* tracheostomy tubes with atraumatic inserter. For details see page 4 to 7.





REF 303



Colour Coding



REF 304



Colour Coding



Tracheostomy Tube

REF 303

In sterile package

- ◆ Outer cannula
- ◆ 2 inner cannulas with 15 mm connector
- ◆ Perforated obturator and wide neck strap (shown on page 22)

Fenestrated Tracheostomy Tube

REF 304

In sterile package

- ◆ Outer cannula, fenestrated
- ◆ Inner cannula, fenestrated, with 15 mm connector
- ◆ Inner cannula with 15 mm connector
- ◆ Occlusion cap for 15 mm connector
- ◆ Perforated obturator and wide neck strap (shown on page 22)

Reference Numbers and Measurements:

REF 301, REF 302, REF 303, REF 304, REF 306 and REF 309

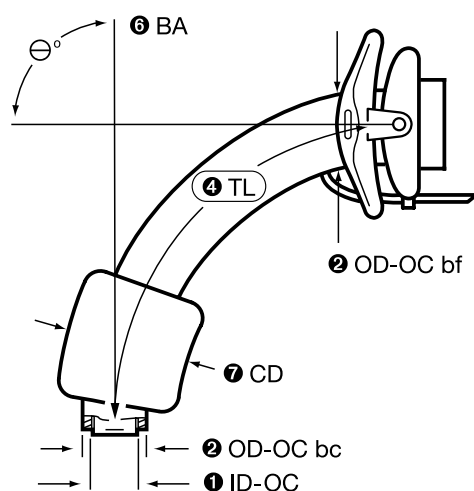

| Size | 1 ID-IC (mm) | 2 OD-OC bc (mm) | 3 OD-OC bf (mm) | Lengths (mm) | | 6 BA (°) | 7 CD (mm) |
|------|--------------------|-----------------------|-----------------------|--------------|---------|----------------|-----------------|
| | | | | 4 TL | 5 AB | | |
| 04 | 4.0 | 7.2 | 8.6 | 56 | 63.0 | 110 | 15 |
| 05 | 5.0 | 8.6 | 10.1 | 66 | 73.0 | 100 | 18 |
| 06 | 6.0 | 9.2 | 10.8 | 72 | 79.5 | 95 | 23 |
| 07 | 7.0 | 10.4 | 12.0 | 74 | 80.5 | 95 | 26 |
| 08 | 8.0 | 11.4 | 12.7 | 76 | 83.0 | 90 | 28 |
| 09 | 9.0 | 12.5 | 14.2 | 78 | 88.5 | 90 | 30 |
| 10 | 10.0 | 13.8 | 15.2 | 80 | 89.5 | 90 | 32 |

1 ID-IC: inside diameter (clear width) at bottom of inner cannula; 2 OD-OC bc: outside diameter at bottom of outer cannula; 3 OD-OC bf: outside diameter of outer cannula behind the flange; 4 Length TL: along centre line from start of neck flange to bottom of tube; 5 Length AB: length along outer bend from start of neck flange to bottom of tube; 6 BA: bending angle; 7 CD: cuff diameter

► To order, specify: REF + size (e.g. REF 306-04).





REF 305



Colour Coding



REF 306



Colour Coding

Laryngectomy Tube

REF 305

In sterile package

- ◆ Outer cannula
- ◆ Inner cannula with 15 mm connector
- ◆ Inner cannula with grooved low profile connector
- ◆ Perforated obturator and wide neck strap (shown on page 22)

Tracheostomy Tube, Unfenestrated, with Low Pressure Cuff and Subglottic Suction Line

REF 306

In sterile package

- ◆ Outer cannula with cuff and subglottic suction line
- ◆ 2 inner cannulas with 15 mm connector
- ◆ 2 connectors for suction devices
- ◆ Perforated obturator and wide neck strap (shown on page 22)

Reference Numbers and Measurements: REF 305

| Size | ① | ② | ③ | Lengths (mm) | | ⑥ |
|------|---------------|------------------|------------------|--------------|---------|-----------|
| | ID-IC (mm) | OD-OC bc (mm) | OD-OC bf (mm) | ④ TL | ⑤ AB | BA (°) |
| 05 | 5.0 | 9.0 | 10.1 | 47 | 52 | 125 |
| 06 | 6.0 | 9.4 | 10.8 | 50 | 56 | 120 |
| 07 | 7.0 | 10.6 | 12.0 | 52 | 59 | 120 |
| 08 | 8.0 | 11.6 | 12.7 | 56 | 63 | 115 |
| 09 | 9.0 | 12.8 | 14.2 | 58 | 66 | 108 |
| 10 | 10.0 | 14.2 | 15.2 | 60 | 70 | 100 |

① ID-IC: inside diameter (clear width) at bottom of inner cannula; ② OD-OC bc: outside diameter at bottom of outer cannula; ③ OD-OC bf: outside diameter of outer cannula behind the flange; ④ Length TL: along centre line from start of neck flange to bottom of tube; ⑤ Length AB: length along outer bend from start of neck flange to bottom of tube; ⑥ BA: bending angle

○ Please refer to the figure on page 23.

▶ To order, specify: REF + size (e.g. REF 305-05).



The reference numbers and measurements for REF 306 to REF 309 can be found on the table on page 23.



REF 888-306



Product Variant:

TRACOE twist Tracheostomy Tube, Fenestrated, with Low Pressure Cuff and Subglottic Suction Line

REF 888-306

In sterile package

- ◆ Outer cannula, fenestrated, with cuff and subglottic suction line
- ◆ Inner cannula with 15 mm connector
- ◆ Inner cannula, fenestrated, with 15 mm connector
- ◆ 2 connectors for suction devices
- ◆ Perforated obturator and wide neck strap (shown on page 22)



REF 309



Colour Coding

Tracheostomy Tube with Low Pressure Cuff and Air Supply Line for Speaking

REF 309

In sterile package

- ◆ Outer cannula with cuff and air supply line for speaking
- ◆ Inner cannula with 15 mm connector
- ◆ Perforated obturator and wide neck strap (shown on page 22)



TRACOE *twist* – Spare Parts and Accessories

REF 501



REF 506



REF 401



Spare Inner Cannulas, Unfenestrated, with 15mm Connector

REF 501 3 units supplied in individual sterile packages

REF 501-X 10 units supplied in individual sterile packages

The inner cannulas are spare parts for *twist* tubes REF 301, REF 302, REF 303, REF 304, REF 306 and REF 309.

Sizes: 04, 05, 06, 07, 08, 09, 10

Spare Inner Cannulas, Fenestrated, with 15mm Connector (light blue)

REF 506 3 units supplied in individual sterile packages

REF 506-X 10 units supplied in individual sterile packages

The inner cannulas are spare parts for *twist* tubes REF 302, REF 304 and REF 888-306.

Sizes: 04, 05, 06, 07, 08, 09, 10

Inner Cannulas, Fenestrated, with Integrated Speaking Valve (light blue)

REF 401 2 units supplied in individual sterile packages

The inner cannulas are accessories for *twist* tubes REF 302 and REF 304.

Sizes: 04, 05, 06, 07, 08, 09, 10

i All fenestrated inner tubes are recognizable by blue parts, e.g. 15 mm connector.

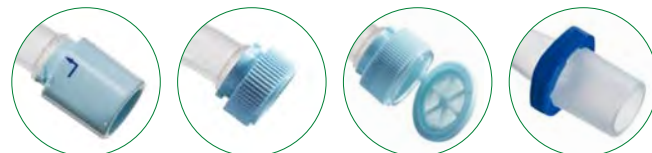

i Accessory for TRACOE *twist* Tubes: Speaking valves and artificial noses (for details see page 60 and 61).



REF 502



REF 507



REF 503



REF 508



***Inner Cannulas, Fenestrated,
with Grooved Low Profile Connector (light blue)***

REF 502 3 units supplied in
individual sterile packages
The inner cannulas are accessories for *twist* tubes
REF 302 and REF 304.
Sizes: 04, 05, 06, 07, 08, 09, 10

***Spare Inner Cannulas, Unfenestrated,
with 15mm Connector***

REF 503 3 units supplied in
individual sterile packages
The inner cannulas are spare parts for *twist* tube
REF 305.
Sizes: 05, 06, 07, 08, 09, 10

***Inner Cannulas, Unfenestrated,
with Grooved Low Profile Connector (white)***

REF 507 3 units supplied in
individual sterile packages
The inner cannulas are accessories for *twist* tube
REF 303.
Sizes: 04, 05, 06, 07, 08, 09, 10

***Spare Inner Cannulas, Unfenestrated, Short,
with Grooved Low Profile Connector (white)***

REF 508 3 units supplied in
individual sterile packages
The inner cannulas are spare parts for *twist* tube
REF 305.
Sizes: 05, 06, 07, 08, 09, 10



TRACOE *twist plus* – Tracheostomy Tubes



REF 311



Colour Coding

NEW!



REF 312



Colour Coding

NEW!

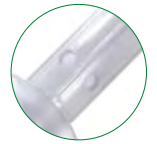

Detail of the additional fenestration at the inner bend



TRACOE *twist plus* Tracheostomy Tube with Low Pressure Cuff

REF 311 In sterile package

- ◆ Outer cannula with cuff
- ◆ 2 inner cannulas with 15 mm connector
- ◆ Perforated Obturator and wide neck strap (shown on page 30)

REF 312 In sterile package

- ◆ Outer cannula, double fenestrated, with cuff
- ◆ Inner cannula with 15 mm connector
- ◆ Inner cannula, double fenestrated, with 15 mm connector
- ◆ Occlusion cap for 15 mm connector
- ◆ Perforated obturator and wide neck strap (shown on page 30)



Features of TRACOE *twist plus* Tracheostomy Tubes:

- ◆ Elongated version of the well-proven TRACOE *twist* tubes.
- ◆ Greatly reduced wall thickness
- ◆ Maximal inner lumen – thin-walled but stable inner cannula
- ◆ Less outer diameter with more inner lumen
- ◆ Less airway resistance
- ◆ New safety locking device for the inner tube
- ◆ Highly improved phonation through double-fenestration of REF 312 and REF 314: multiple fenestration at the outer bend as well as two additional phonation holes at the inner bend.



TRACOE *twist plus* Colour Coding:

++ REF 311 ++ REF 312 ++ REF 313
++ REF 314 ++ REF 316

The colour coding is conspicuously printed on each box. This helps you organise your inventory and quickly and reliably locate the right tube.



REF 311-P, REF 312-P and REF 316-P:

TRACOE *twist plus* Tracheostomy tubes with atraumatic insertion system. For details see pages 8 to 11.





Detail of the additional fenestration at the inner bend



REF 313



Colour Coding

NEW!

REF 314



Colour Coding

NEW!

TRACOE *twist plus* Tracheostomy Tube

REF 313

In sterile package

- ◆ Outer cannula
- ◆ 2 inner cannulas with 15 mm connector
- ◆ Perforated Obturator and wide neck strap (shown on page 30)

TRACOE *twist plus* Tracheostomy Tube, Double Fenestrated

REF 314

In sterile package

- ◆ Outer cannula, double fenestrated
- ◆ Inner cannula with 15 mm connector
- ◆ Inner cannula, double fenestrated, with 15 mm connector
- ◆ Occlusion cap for 15 mm connector
- ◆ Perforated obturator and wide neck strap (shown on page 30)

twist plus

Reference Numbers and Measurements:

REF 311, REF 312, REF 313, REF 314 and REF 316

| Size | 1 ID-IC (mm) | 2 OD-OC bc (mm) | 3 OD-OC bf (mm) | Lengths (mm) | | 6 BA (°) | 7 CD (mm) |
|------|--------------------|-----------------------|-----------------------|--------------|---------|----------------|-----------------|
| | | | | 4 TL | 5 AB | | |
| 07 | 7,0 | 9,8 | 10,1 | 85 | 91 | 100 | 26 |
| 08 | 8,0 | 10,8 | 11,1 | 88 | 95 | 100 | 28 |
| 09 | 9,0 | 11,8 | 12,1 | 90 | 99 | 100 | 30 |
| 10 | 10,0 | 12,8 | 13,1 | 92 | 102 | 100 | 32 |

1 ID-IC: inside diameter (clear width) at bottom of inner cannula; 2 OD-OC bc: outside diameter at bottom of outer cannula; 3 OD-OC bf: outside diameter of outer cannula behind the flange; 4 Length TL: along centre line from start of neck flange to bottom of tube; 5 Length AB: length along outer bend from start of neck flange to bottom of tube; 6 BA: bending angle; 7 CD: cuff diameter

► To order, specify: REF + size (e.g. REF 311-08).

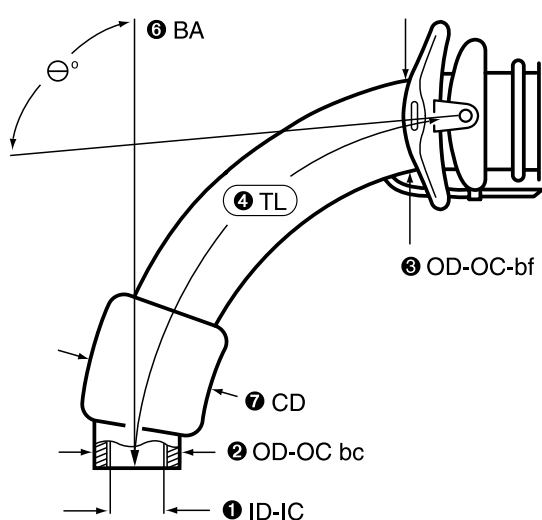

Legend to symbol:



Fenestrated tube



REF 316



Colour Coding

NEW!



REF 888-316

NEW!

Detail of the additional fenestration at the inner bend

TRACOE *twist plus* Tracheostomy Tube, Unfenestrated, with Low Pressure Cuff and Subglottic Suction Line

REF 316

In sterile package

- ◆ Outer cannula with cuff and subglottic suction line
- ◆ 2 inner cannulas with 15 mm connector
- ◆ 2 connectors for suction devices
- ◆ Perforated obturator and wide neck strap (shown below)

Product Variant:

TRACOE *twist plus* Tracheostomy Tube, Double Fenestrated, with Low Pressure Cuff and Subglottic Suction Line

REF 888-316

In sterile package

- ◆ Outer cannula, double fenestrated, with cuff and subglottic suction line
- ◆ Inner cannula with 15 mm connector
- ◆ Inner cannula, double fenestrated, with 15 mm connector
- ◆ 2 connectors for suction devices
- ◆ Perforated obturator and wide neck strap (shown below)



All TRACOE *twist plus* tubes are delivered with inserted inner cannula and therein, preinstalled, the obturator.



Each TRACOE *twist plus* is supplied with a perforated obturator and a wide adjustable neck strap as well as a tube info card with peel-off stickers on front and back. The neck strap is also available separately (REF 903-F).



REF 521

NEW!



REF 523

NEW!



*Detail of the additional
two phonation holes
at the inner bend*

Spare Inner Cannulas, Unfenestrated, with 15mm Connector

REF 521 3 units supplied in
individual sterile packages

REF 521-X 10 units supplied in
individual sterile packages

The inner cannulas are spare parts for *twist* plus tubes REF 311, REF 312, REF 313, REF 314 and REF 316.

Sizes: 07, 08, 09, 10

Spare Inner Cannulas, Double Fenestrated, with 15mm Connector

REF 523 3 units supplied in
individual sterile packages

REF 523-X 10 units supplied in
individual sterile packages

The inner cannulas are spare parts for *twist* plus tubes REF 312, REF 314 and REF 888-316.

Sizes: 07, 08, 09, 10





A Perfect Fit

The flexible tube with patented, variably adjustable neck flange. It allows the correct adjustment in length.

TRACOE®

vario

Patented

TRACOE *vario* – the flexible tube with the patented, variably adjustable neck flange. By means of a practical pressure mechanism, the neck flange can be moved and, thus, be adjusted individually to any patient. A scale ensures the exact positioning of the neck flange in preparation to change tubes (a). The flange is fixed immediately after its release. Additionally as an optional precaution, the neck flange can be securely locked by pulling up the orange lever system (b). Since no screw top is used, no pressure of any kind will be exerted on the trachea.

Numerous Adaptabilities

The pliable wings on the flange can be adjusted independently of one another (c). This provides additional possibilities for meeting the unique anatomical requirements of each patient.

TRACOE *vario* tracheostomy tubes come in many different versions: reinforced with a metal spiral or made of clear plastic (with an X-ray contrast line), with or without low pressure cuff, with subglottic suction line and in an extra-long version.

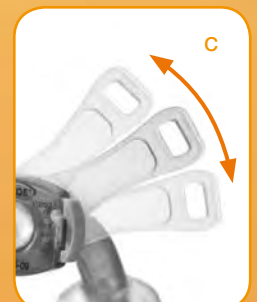

TRACOE vario – Tracheostomy Tubes



REF 450



Colour Coding



REF 455



Colour Coding

Tracheostomy Tube Spiral-Reinforced, with Adjustable Neck Flange and Low Pressure Cuff

REF 450

In sterile package

- ◆ Cannula with 15 mm connector, spiral-reinforced, with cuff and scale
- ◆ Obturator and wide neck strap (shown below)

Tracheostomy Tube Spiral-Reinforced, with Adjustable Neck Flange

REF 455

In sterile package

- ◆ Cannula with 15 mm connector, spiral-reinforced, with scale
- ◆ Obturator and wide neck strap (shown below)



TRACOE vario Colour Coding:

● REF 450 ● REF 455 ● REF 460 ● REF 470

● XL REF 451 ● XL REF 461 ● XL REF 471

The colour coding is conspicuously printed on each box. This helps you organise your inventory and quickly and reliably locate the right tube.



Each TRACOE vario tube is supplied with an

obturator and a wide adjustable neck strap as well as a tube info card with peel-off stickers on front and back. The neck strap is also available separately (REF 903-F).

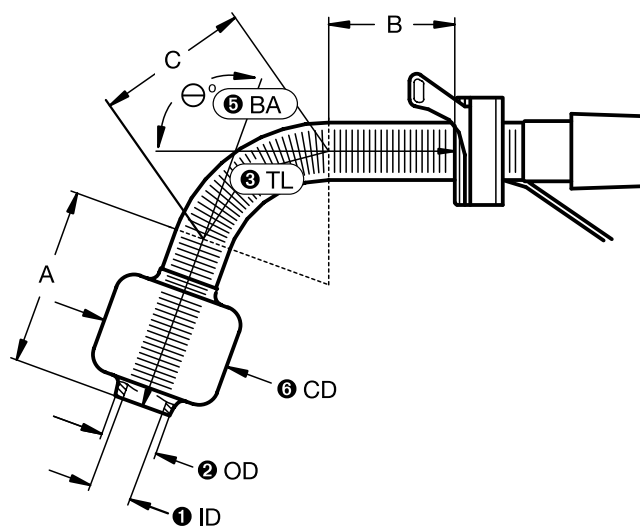



REF 460



Colour Coding

Tracheostomy Tube with Adjustable Neck Flange and Low Pressure Cuff

REF 460 *In sterile package*

- ♦ Cannula with 15 mm connector, cuff, X-ray contrast line and scale
- ♦ Obturator and wide neck strap (shown on page 34)

Reference Numbers and Measurements: REF 450, REF 455 and REF 460

| Size | ❶ ID (mm) | ❷ OD (mm) | Lengths (mm) | | | | | ❸ BA (°) | ❹ CD (mm) |
|------|--------------|--------------|--------------|----|----|------|------|-------------|--------------|
| | | | A | C | B | ❶ TL | ❷ AB | | |
| 06 | 6.0 | 8.2 | 30 | 28 | 12 | 70 | 76 | 100 | 23 |
| 07 | 7.0 | 9.7 | 33 | 32 | 15 | 80 | 86 | 100 | 26 |
| 08 | 8.0 | 11.2 | 35 | 35 | 20 | 90 | 97 | 100 | 28 |
| 09 | 9.0 | 12.3 | 38 | 35 | 27 | 100 | 106 | 100 | 30 |
| 10 | 10.0 | 13.7 | 38 | 37 | 35 | 110 | 120 | 100 | 32 |
| 11 | 11.0 | 14.8 | 38 | 37 | 35 | 110 | 121 | 100 | 34 |

❶ ID: inside diameter (clear width) at bottom of cannula; ❷ OD: outside diameter at bottom of cannula; ❸ TL: length along centre line; ❷ AB: length along outer bend; ❸ BA: bending angle; ❹ CD: cuff diameter (REF 450 and REF 460)

► To order, specify REF + size (e.g. REF 450-06).

TRACOE vario – Tracheostomy Tubes, extra-long



REF 451

XL

Colour Coding



REF 461

XL

Colour Coding

NEW!

TRACOE vario XL Tracheostomy Tube, Extra-Long, Spiral-Reinforced, with Adjustable Neck Flange and Low Pressure Cuff

REF 451

In sterile package

- ◆ Cannula with 15 mm connector, spiral-reinforced, with cuff and scale
- ◆ Obturator and wide neck strap (shown on page 34)

TRACOE vario XL Tracheostomy Tube, Extra-Long, with Adjustable Neck Flange and Low Pressure Cuff

REF 461

In sterile package

- ◆ Cannula with 15 mm connector, cuff, X-ray contrast line and scale
- ◆ Obturator and wide neck strap (shown on page 34)

Reference Numbers and Measurements: REF 451, REF 461 and REF 471

| Size | ❶ ID (mm) | ❷ OD (mm) | Lengths (mm) | | | | | ❸ BA (°) | ❹ CD (mm) |
|------|-----------|-----------|--------------|----|----|------|------|----------|-----------|
| | | | A | C | B | ❸ TL | ❹ AB | | |
| 07 | 7.0 | 9.7 | 35 | 36 | 33 | 104 | 110 | 100 | 26 |
| 08 | 8.0 | 11.2 | 37 | 46 | 40 | 123 | 128 | 100 | 28 |
| 09 | 9.0 | 12.3 | 38 | 46 | 42 | 126 | 134 | 100 | 30 |
| 10 | 10.0 | 13.7 | 38 | 52 | 45 | 135 | 146 | 100 | 32 |

Reference Numbers and Measurements: REF 470

| | | | | | | | | | |
|----|------|------|----|----|----|-----|-----|-----|----|
| 07 | 7.0 | 9.7 | 33 | 32 | 15 | 80 | 86 | 100 | 26 |
| 08 | 8.0 | 11.2 | 35 | 35 | 20 | 90 | 97 | 100 | 28 |
| 09 | 9.0 | 12.3 | 38 | 35 | 27 | 100 | 106 | 100 | 30 |
| 10 | 10.0 | 13.7 | 38 | 37 | 35 | 110 | 120 | 100 | 32 |

❶ ID: inside diameter (clear width) at bottom of cannula; ❷ OD: outside diameter at bottom of cannula; ❸ TL: length along centre line; ❹ AB: length along outer bend; ❺ BA: bending angle, ❻ CD: cuff diameter

⦿ Please refer to the figure on page 34.

▶ To order, specify REF + size (e.g. REF 451-07).



Accessory for
TRACOE vario Tubes

- ◆ Artificial noses (for details see page 61)

TRACOE vario – Tracheostomy Tubes, with Subglottic Suction Line



REF 470



Colour Coding



REF 471



Colour Coding

NEW!

TRACOE vario extract Tracheostomy Tube with Adjustable Neck Flange, Low Pressure Cuff and Subglottic Suction Line

REF 470

In sterile package

- ◆ Cannula with 15 mm connector, cuff, X-ray contrast line, scale and subglottic suction line
- ◆ 2 connectors for suction pump
- ◆ Obturator and wide neck strap (shown on page 34)

TRACOE vario XL extract Tracheostomy Tube, Extra-Long, with Adjustable Neck Flange, Low Pressure Cuff and Subglottic Suction Line

REF 471

In sterile package

- ◆ Cannula with 15 mm connector, cuff, X-ray contrast line, scale and subglottic suction line
- ◆ 2 connectors for suction pump
- ◆ Obturator and wide neck strap (shown on page 34)



REF 470 and REF 471, with subglottic suction line. Advantages and Special Information:

- ◆ Accumulated subglottic secretions can be suctioned off at the lowest point, in other words right above the cuff. This reduces the risk of bacterially contaminated secretions entering the lower respiratory tract and the risk of developing aspiration pneumonia.
- ◆ The suction line is integrated in the wall of the tube to avoid any pressure marks in the tracheostoma. Via this line, secretions can be suctioned off.
- ◆ The variably adjustable neck flange with rotating wings permits universal adjustment to any neck anatomy (e.g. thick necks, postoperative oedema, asymmetrical necks).



REF 450-P, REF 451-P, REF 460-P, RE 461-P, REF 470-P and REF 471-P:

TRACOE vario tracheostomy tubes with atraumatic insertion system. For details refer to page 12 to 17.



TRACOE®

pure

Large Range of Sizes

The TRACOE *pure* tube is supplied in sizes 5.0 to 10.0 finely differentiated in steps of 0.5 mm. This permits selection of the right tube for a precise fit in any anatomical situation.

Proven TRACOE Specifications

The TRACOE *pure* tracheostomy tube also includes many proven TRACOE specifications: e.g. the transparent design for easier detection of soiling.

A Clear Case

Transparent design,
11 different sizes in steps
of 0.5 mm – the economical
version for short-term use.

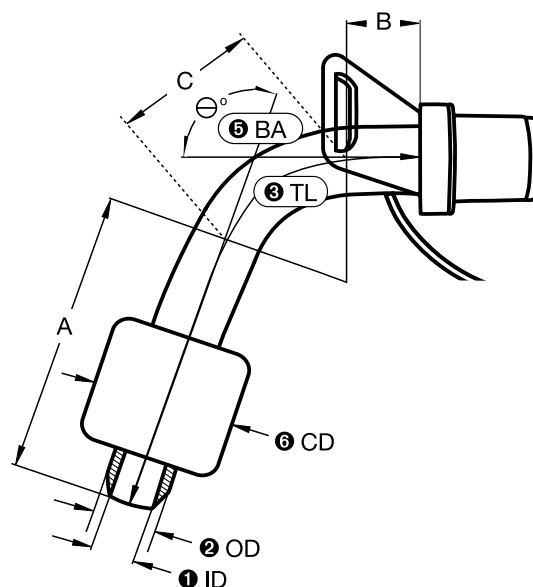



REF 480



Colour Coding

Tracheostomy Tube with Low Pressure Cuff

REF 480

In sterile package

- ◆ Cannula with cuff
- ◆ Perforated obturator
- ◆ Wide neck strap
- ◆ Tube info card with peel-off stickers on front and back



Accessory for TRACOE *pure* Tube:

- ◆ Artificial noses (for details see page 61)
- ◆ REF 517, Seldinger guide wire with guiding catheter (for details see page 19)
- ◆ REF 518, Seldinger guide wire (for details see page 19)



TRACOE *pure* Colour Coding:

● REF 480: The colour coding is conspicuously printed on each box. This helps you organise your inventory and quickly and reliably locate the right tube.

Reference Numbers and Measurements: REF 480

| Size | ① ID (mm) | ② OD (mm) | A | C | Lengths (mm) B | ③ TL | ④ AB | ⑤ BA (°) | ⑥ CD (mm) |
|------|--------------|--------------|----|----|-------------------|--------|------|-------------|--------------|
| 5.0 | 5.0 ± 0.2 | 6.7 ± 0.2 | 32 | 22 | 10 | 64 ± 2 | 69 | 95-100 | 17 |
| 5.5 | 5.5 ± 0.2 | 7.4 ± 0.2 | 32 | 25 | 10 | 67 ± 2 | 74 | 95-100 | 17 |
| 6.0 | 6.0 ± 0.2 | 8.4 ± 0.2 | 33 | 25 | 12 | 70 ± 2 | 77 | 95-100 | 20 |
| 6.5 | 6.5 ± 0.2 | 9.1 ± 0.2 | 33 | 28 | 12 | 73 ± 2 | 80 | 95-100 | 20 |
| 7.0 | 7.0 ± 0.2 | 9.8 ± 0.2 | 33 | 29 | 14 | 76 ± 2 | 85 | 95-100 | 22 |
| 7.5 | 7.5 ± 0.2 | 10.3 ± 0.2 | 34 | 33 | 14 | 81 ± 2 | 89 | 95-100 | 22 |
| 8.0 | 8.0 ± 0.2 | 11.0 ± 0.2 | 35 | 34 | 16 | 85 ± 2 | 94 | 95-100 | 24 |
| 8.5 | 8.5 ± 0.2 | 11.5 ± 0.2 | 36 | 36 | 16 | 88 ± 2 | 97 | 95-100 | 24 |
| 9.0 | 9.0 ± 0.2 | 12.0 ± 0.2 | 38 | 37 | 17 | 92 ± 2 | 100 | 95-100 | 26 |
| 9.5 | 9.5 ± 0.2 | 12.5 ± 0.2 | 40 | 39 | 17 | 96 ± 2 | 106 | 95-100 | 26 |
| 10.0 | 10.0 ± 0.2 | 13.0 ± 0.2 | 41 | 39 | 18 | 98 ± 2 | 109 | 95-100 | 28 |

① ID: inside diameter (clear width) at bottom of tube; ② OD: outside diameter at bottom of tube; ③ TL: length along centre line; ④ AB: length along outer bend; ⑤ BA: bending angle; ⑥ CD: cuff diameter

► To order, specify: REF + size (e.g. REF 480-5.0).



TRACOE®



TRACOE®
REF 355
PEDIATRIC

***Small in Size,
Big in Performance:***

TRACOE *mini*.
The special tube for
neonates and children.
Extremely soft, thin-walled
and kink resistant.

TRACOE®

mini



The Smaller, the Greater

Sometimes the greatest achievements are made on a small scale: A prime example is the TRACOE *mini* – the product line especially developed for newborns, infants and children. TRACOE *mini* tracheostomy tubes are particularly soft and equipped with a neck flange with a slanted bottom, providing the tube with an optimised and atraumatic fit. These tubes have very thin walls to meet the special requirements of use in small patients, however, they reliably retain their shape at all times. The smooth, funnel-shaped inner design of the 15mm connector allows an easy insertion of suction catheters.

Easy and Reliable

The special obturator is extremely practical. The grip on its end makes sure that the tube can be easily and reliably inserted despite its small size. Neck straps and compresses are also available to match.

Anatomically Optimum Solutions

So the best solution can be found for every small patient. TRACOE *mini* is available in 12 different sizes: 4 for neonates and 8 for pediatric use.



TRACOE *mini* – Tracheostomy Tubes



REF 350



Colour Coding



REF 355



Colour Coding



Tracheostomy Tube for Neonates

REF 350

In sterile package

- ◆ Cannula
- ◆ Obturator and neck strap (shown below)

Tracheostomy Tube for Children

REF 355

In sterile package

- ◆ Cannula
- ◆ Obturator and neck strap (shown below)



Product variants REF 355:

Product variants can be made in order to optimise the functionality and wearing comfort and also for patients with complex anatomical and physiological conditions. Product variations have green writing on the neck flange.



TRACOE *mini* Colour Coding:

● REF 350 ● REF 355

The colour coding is conspicuously printed on each box. This helps you organise your inventory and quickly and reliably locate the right tube.



Each TRACOE *mini* tube is supplied with

an obturator, a wide adjustable neck strap and a tube info card with detachable stickers on front and back. The neck strap is also available separately (REF 903-G).

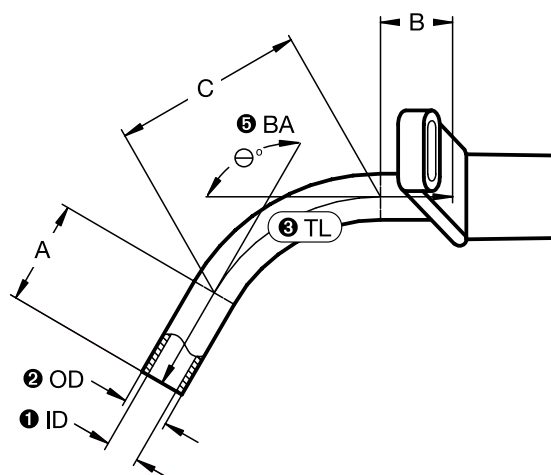

Accessories

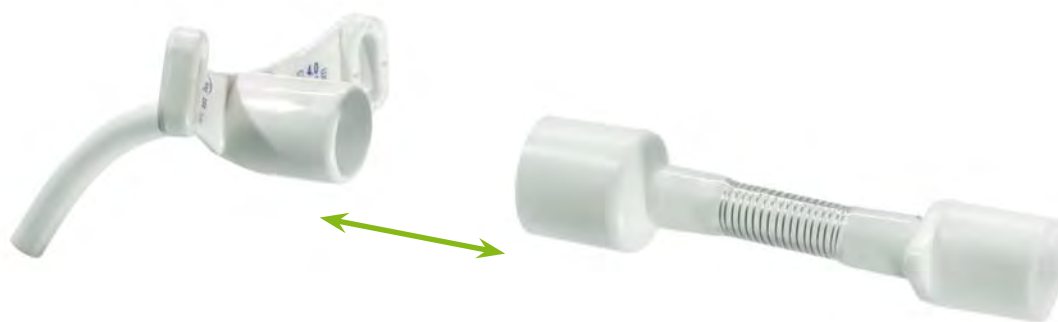

REF 356

NEW!



Special accessories for TRACOE mini

such as neck strap and compresses, can be found on pages 76, 83 and 84 as part of the TRACOE care line of accessories.

TRACOE mini Extension Piece

REF 356

In sterile package

- ◆ Extension piece
- ◆ Disconnecting aid (wedge)
- ◆ Product information card with peel-off sticker on front and back

Prevents obstruction of the patient end of the tube.
Fits all *mini* tubes.

Reference Numbers and Measurements: REF 350

| Size | ① ID (mm) | ② OD (mm) | Lengths (mm) | | | | ⑤ BA (°) | |
|------|-----------|-----------|--------------|----|---|------|----------|-----|
| | | | A | C | B | ③ TL | ④ AB | |
| 2.5 | 2.5 | 3.6 | 6 | 22 | 2 | 30 | 32 | 120 |
| 3.0 | 3.0 | 4.3 | 7 | 23 | 2 | 32 | 34 | 120 |
| 3.5 | 3.5 | 5.0 | 8 | 23 | 3 | 34 | 37 | 120 |
| 4.0 | 4.0 | 5.6 | 9 | 24 | 3 | 36 | 40 | 120 |

Reference Numbers and Measurements: REF 355

| Size | ① ID (mm) | ② OD (mm) | A | C | B | ③ TL | ④ AB | ⑤ BA (°) |
|------|-----------|-----------|----|----|---|------|------|----------|
| 2.5 | 2.5 | 3.6 | 8 | 22 | 2 | 32 | 34 | 120 |
| 3.0 | 3.0 | 4.3 | 10 | 24 | 2 | 36 | 39 | 120 |
| 3.5 | 3.5 | 5.0 | 12 | 25 | 3 | 40 | 43 | 120 |
| 4.0 | 4.0 | 5.6 | 14 | 27 | 3 | 44 | 48 | 120 |
| 4.5 | 4.5 | 6.3 | 16 | 28 | 4 | 48 | 52 | 120 |
| 5.0 | 5.0 | 7.0 | 18 | 28 | 4 | 50 | 55 | 120 |
| 5.5 | 5.5 | 7.6 | 20 | 30 | 5 | 55 | 60 | 120 |
| 6.0 | 6.0 | 8.4 | 22 | 35 | 5 | 62 | 67 | 120 |

① ID: inside diameter (clear width) of tube; ② AD: outside diameter of tube; ③ TL: length along centre line from start of neck flange to bottom of tube; ④ AB: length along outer bend from start of neck flange to bottom of tube; ⑤ BW: bending angle

► To order, specify REF + size (e.g. REF 355-2.5).

Measurements in mm:

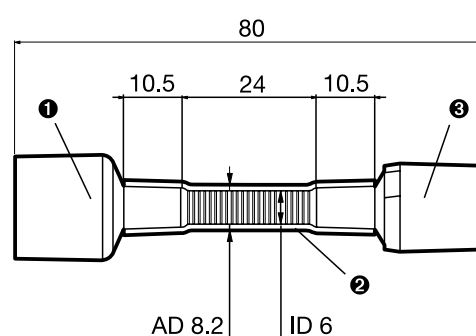

- ① 15 mm Connector, female
- ② Reinforced Tube
- ③ 15 mm Connector, male



Superb Quality

TRACOE *comfort*:
Tradition and five decades
of continual improvements.
Especially soft and flexible
to maximise wearing comfort.
Large selection of types and
sizes, including tube variants
on request.

TRACOE®

comfort

Lightweight, Soft and Flexible

TRACOE *comfort* tracheostomy tubes are made of clear medical-grade polymer material, which makes them both especially soft and very lightweight. They do not have to be removed for X-ray or cobalt therapy. A TRACOE *comfort* tube weighs only about one-third of a silver tube of the same size. Because they are transparent, it is also very easy to ensure that they are perfectly clean.

As Comfortable as Possible

As the name suggests, TRACOE *comfort* tubes are designed to be as comfortable as possible for permanent wearers after tracheostomy or laryngectomy. Their discreet appearance is an added benefit. To ensure optimum quality, they are still made by hand – an extra effort that does a world of good to the patient.

Many Models and Sizes

Every tube model comes in many different sizes and lengths. This variety makes it possible, to, e.g., avoid bruises at the tracheostoma and/or in the trachea, which would result in further impediments for the patient.

TRACOE *comfort* – Tracheostomy Tubes



REF 101

Tube without Inner Cannula

REF 101

- ◆ Cannula
- ◆ Wide neck strap (shown on page 47)

For acute tracheostomy and emergency care applications.

REF 102

Tube with Inner Cannula

REF 102

- ◆ Outer cannula
 - ◆ Inner cannula
 - ◆ Wide neck strap (shown on page 47)
- For permanent wearers.

i Tubes of size 03, 04, 13 and 14 are made to order.
Delivery time is approx. 10 working days.

Reference Numbers and Measurements: REF 101 to REF 105-D

| Size | ① ID-OC (mm) | ② OD-OC bc (mm) | ③ OD-OC hf (mm) | ④ ID-IC (mm) | Lengths (mm) | | ① ID-OC: inside diameter (clear width) at bottom of outer cannula; ② OD-OC bc: outside diameter at bottom of outer cannula; ③ OD-OC hf: outside diameter of outer cannula behind the flange; ④ ID-IC: inside diameter at bottom of inner cannula; ⑤ Length TL: length along centre line from start of neck flange to bottom of tube; ⑥ Length AB: length along outer bend (greatest length) ☉ The bending angle is 90° in <i>comfort</i> tubes. |
|------|--------------------|-----------------------|-----------------------|--------------------|--------------|------|--|
| | | | | | ⑤ TL | ⑥ AB | |
| 03 | 3.5 | 4.8 | 6.4 | 2.6 | 42 | 46 | |
| 04 | 4.0 | 5.6 | 7.3 | 3.2 | 50 | 55 | |
| 05 | 5.0 | 6.7 | 8.7 | 4.0 | 52 | 57 | |
| 06 | 6.0 | 7.6 | 10.0 | 4.8 | 54 | 60 | |
| 07 | 7.0 | 8.8 | 10.5 | 5.8 | 57 | 65 | |
| 08 | 8.0 | 10.0 | 11.3 | 6.8 | 61 | 70 | |
| 09 | 9.0 | 11.4 | 12.6 | 7.6 | 65 | 75 | |
| 10 | 10.0 | 12.4 | 13.7 | 8.7 | 74 | 85 | |
| 11 | 11.0 | 13.1 | 15.0 | 9.7 | 76 | 87 | |
| 12 | 12.0 | 14.2 | 16.2 | 10.8 | 78 | 90 | |
| 13 | 13.0 | 15.4 | 17.2 | 11.8 | 87 | 100 | |
| 14 | 14.0 | 16.6 | 18.2 | 12.6 | 91 | 105 | |

► To order, specify: REF + size (e.g. REF 105-05).



REF 102-D



REF 103



Tube with Inner Cannulas

REF 102-D

- ◆ Outer cannula
 - ◆ Two inner cannulas
 - ◆ Wide neck strap (shown below)
- For permanent wearers.

Tube, Fenestrated, with Slide-On Speaking Valve, Type A

REF 103

- ◆ Outer cannula, fenestrated
- ◆ Inner cannula, fenestrated, with slide-on silver valve type A
- ◆ Inner cannula
- ◆ Wide neck strap (shown below)

For tracheostomised patients with fully or partially intact larynx, for speaking.



REF 103-O:

Product variant of REF 103 with additional oxygen supply port attached to the inner cannula with speaking valve.



Each TRACOE *comfort* tube is supplied with an adjustable neck strap and a tube info card with peel-off stickers on front and back. The neck strap is also available separately (REF 903-F).

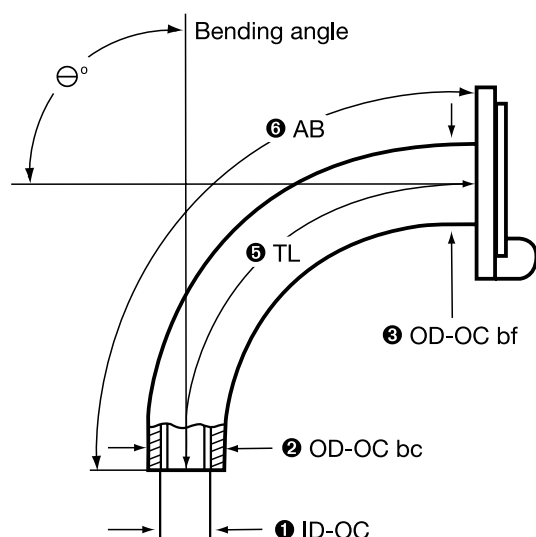



REF 103-A



**Tube, Fenestrated,
with Slide-On Speaking Valve, Type A**

REF 103-A

- ◆ Outer cannula, fenestrated
- ◆ Inner cannula, fenestrated, with slide-on silver valve type A
- ◆ Inner cannula with 15 mm connector
- ◆ Inner cannula
- ◆ Wide neck strap (shown on page 47)

For tracheostomised patients with fully or partially intact larynx, for speaking.



REF 103-A-O:

Product variant of REF 103-A with additional oxygen supply port attached to the inner cannula with speaking valve.



Product variants:

Product variants can be made in order to optimise the functionality and wearing comfort and also for patients with complex anatomical and physiological conditions.



REF 104



**Tube, Fenestrated,
with Swivel Speaking Valve, Type B**

REF 104

- ◆ Outer cannula, fenestrated
- ◆ Inner cannula, fenestrated, with swivel valve type B
- ◆ Inner cannula
- ◆ Wide neck strap (shown on page 47)

For tracheostomised patients with fully or partially intact larynx, for speaking.



REF 104-O:

Product variant of REF 104 with additional oxygen supply port attached to the inner cannula with speaking valve.



Accessory for TRACOE comfort Tubes:

- ◆ Speaking valves, occlusion caps and artificial noses (for details see page 60 and 61)
- ◆ REF 517, Seldinger guide wire with guiding catheter (for details see page 19)
- ◆ REF 518, Seldinger guide wire (for details see page 19)



REF 104-A



REF 114

Tube, Fenestrated, with Swivel Speaking Valve, Type B

REF 104-A

- ◆ Outer cannula, fenestrated
- ◆ Inner cannula, fenestrated, with swivel valve type B
- ◆ Inner cannula with 15 mm connector
- ◆ Inner cannula
- ◆ Wide neck strap (shown on page 47)

For tracheostomised patients with fully or partially intact larynx, for speaking.



REF 104-A-O:

Product variant of REF 104-A with additional oxygen supply port attached to the inner cannula with speaking valve.



The reference numbers and measurements for REF 104-A to REF 105-D can be found on the table on page 46.

Tube, Fenestrated, with Swivel Speaking Valve, Type B

REF 114

- ◆ Outer cannula, fenestrated
- ◆ Inner cannula, fenestrated, with swivel valve type B
- ◆ Inner cannula with 15 mm connector
- ◆ Wide neck strap (shown on page 47)

For tracheostomised patients with fully or partially intact larynx, for speaking.

Reference Numbers and Measurements: REF 114 and REF 115

| Size | ① ID-OC (mm) | ② OD-OC bc (mm) | ③ OD-OC bf (mm) | ④ ID-IC (mm) | Lengths (mm) | |
|------|--------------------|-----------------------|-----------------------|--------------------|--------------|------|
| | | | | | ⑤ TL | ⑥ AB |
| 07 | 7.0 | 8.8 | 10.5 | 5.8 | 57 | 65 |
| 08 | 8.0 | 10.0 | 11.3 | 6.8 | 61 | 70 |
| 09 | 9.0 | 11.4 | 12.6 | 7.6 | 65 | 75 |

① ID-OC: inside diameter (clear width) at bottom of outer cannula; ② OD-OC bc: outside diameter at bottom of outer cannula; ③ OD-OC bf: outside diameter of outer cannula behind the flange; ④ ID-IC: inside diameter at bottom of inner cannula; ⑤ Length TL: length along centre line from start of neck flange to bottom of tube; ⑥ Length AB: length along outer bend (greatest length)

○ The bending angle is 90° in *comfort* tubes.

○ Please refer to the figure on page 47.

► To order, specify: REF + size (e.g. REF 114-07).





REF 105

Tube with 15 mm Connector

REF 105

- ◆ Outer cannula
- ◆ Inner cannula with 15 mm connector
- ◆ Wide neck strap (shown on page 47)

For attaching:

TRACOE humid assist I (REF 640-CT),
TRACOE humid assist III (REF 641) and
TRACOE humid assist IV (REF 642).

Further information see page 58 to 61.



REF 105-D

Tube with 15 mm Connector

REF 105-D

- ◆ Outer cannula
- ◆ Two inner cannulas with 15 mm connector
- ◆ Wide neck strap (shown on page 47)

For attaching:

TRACOE humid assist I (REF 640-CT),
TRACOE humid assist III (REF 641) and
TRACOE humid assist IV (REF 642).

Further information see page 58 to 61.



REF 115



Tube, Fenestrated, with 15 mm Connector

REF 115

- ◆ Outer cannula, fenestrated
- ◆ Inner cannula, fenestrated, with 15 mm connector
- ◆ Inner cannula with 15mm connector
- ◆ Wide neck strap (shown on page 47)

For attaching:

TRACOE phon assist (e.g. REF 650-T) and

TRACOE humid assist (e.g. REF 640-CT).

Further information see page 58 to 61.

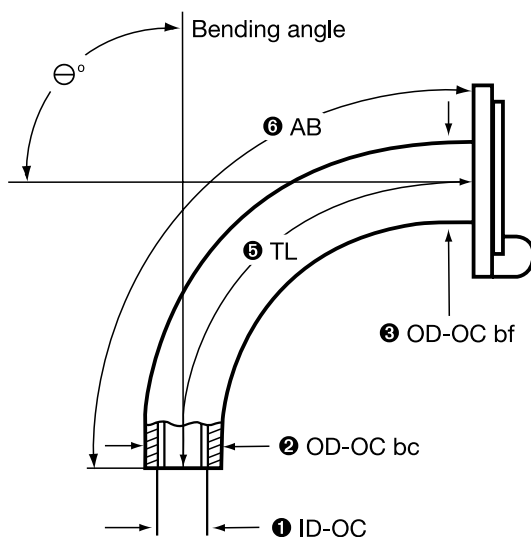

Legend to symbol:



Fenestrated tube



REF 106-D

Laryngectomy Tube

REF 106-D

- ◆ Outer cannula, short
- ◆ Two inner cannulas, short
- ◆ Wide neck strap (shown on page 47)

For patients whose larynx has been removed.

The length and bending angle are designed for an optimum fit.

Reference Numbers and Measurements: REF 106-D

| Size | 1 | 2 | 3 | 4 | Lengths (mm) | |
|------|------------|---------------|---------------|------------|--------------|------|
| | ID-OC (mm) | OD-OC bc (mm) | OD-OC bf (mm) | ID-IC (mm) | 5 TL | 6 AB |
| 07 | 7.0 | 8.8 | 10.5 | 5.8 | 47 | 50 |
| 08 | 8.0 | 10.0 | 11.3 | 6.8 | 50 | 53 |
| 09 | 9.0 | 11.4 | 12.6 | 7.6 | 52 | 57 |
| 10 | 10.0 | 12.4 | 13.7 | 8.7 | 55 | 60 |
| 11 | 11.0 | 13.1 | 15.0 | 9.7 | 58 | 63 |
| 12 | 12.0 | 14.2 | 16.2 | 10.8 | 60 | 66 |

1 ID-OC: inside diameter (clear width) at bottom of outer cannula; 2 OD-OC bc: outside diameter at bottom of outer cannula; 3 OD-OC bf: outside diameter of outer cannula behind the flange; 4 ID-IC: inside diameter at bottom of inner cannula; 5 Length TL: length along centre line from start of neck flange to bottom of tube; 6 Length AB: length along outer bend (greatest length)

⊙ The bending angle is 90° in *comfort* tubes.

► Bestellnummer: REF + Größe, z. B. REF 106-D-07

TRACOE *comfort* – Tracheostomy Tubes, extra-long (Hautant)



REF 201



REF 202



REF 202-D

Extra-Long Tube without Inner Cannula

REF 201

- ◆ Cannula, extra-long
 - ◆ Wide neck strap (shown on page 53)
- For acute tracheostomy and emergency care applications.

Extra-Long Tube with Inner Cannula

REF 202

- ◆ Outer cannula, extra-long
 - ◆ Inner cannula
 - ◆ Wide neck strap (shown on page 53)
- For permanent wearers and patients with tracheal stenosis.

Extra-Long Tube with Inner Cannulas

REF 202-D

- ◆ Outer cannula, extra-long
 - ◆ Two inner cannulas
 - ◆ Wide neck strap (shown on page 53)
- For permanent wearers and patients with tracheal stenosis.

Reference Numbers and Measurements: REF 201 to REF 205, REF 214 and REF 215

| Size | ❶ | ❷ | ❸ | ❹ | Lengths (mm) | | ❶ ID-OC: inside diameter (clear width) at bottom of outer cannula; ❷ OD-OC bc: outside diameter at bottom of outer cannula; ❸ OD-OC bf: outside diameter of outer cannula behind the flange; ❹ ID-IC: inside diameter at bottom of inner cannula; ❺ Length TL: length along centre line from start of neck flange to bottom of tube; ❻ Length AB: length along outer bend (greatest length) |
|--|------------|---------------|---------------|------------|--------------|------|---|
| | ID-OC (mm) | OD-OC bc (mm) | OD-OC bf (mm) | ID-IC (mm) | ❺ TL | ❻ AB | |
| 05 | 5.0 | 6.6 | 9.0 | 4.0 | 85 | 92 | ⦿ The bending angle is 90° in <i>comfort</i> tubes. ⦿ Please refer to the figure on page 54. |
| 06 | 6.0 | 7.7 | 9.8 | 5.0 | 87 | 95 | |
| 07 | 7.0 | 8.7 | 10.5 | 6.0 | 93 | 100 | |
| 08 | 8.0 | 10.5 | 12.2 | 6.7 | 96 | 105 | |
| 09 | 9.0 | 11.5 | 13.0 | 7.5 | 100 | 110 | |
| 10 | 10.0 | 12.5 | 14.5 | 8.8 | 104 | 115 | |
| 11 | 11.0 | 13.5 | 15.5 | 9.2 | 108 | 120 | |
| 12 | 12.0 | 14.4 | 16.4 | 10.0 | 112 | 125 | |
| 13 | 13.0 | 15.4 | 18.0 | 11.8 | 116 | 130 | |
| 14 | 14.0 | 16.4 | 18.2 | 12.6 | 122 | 135 | |
| ▶ To order, specify: REF + size (e.g. REF 205-05). | | | | | | | |

- ⊙ The bending angle is 90° in *comfort* tubes.
- ⊙ Please refer to the figure on page 54.



REF 203



REF 204



Extra-Long Tube, Fenestrated, with Slide-On Speaking Valve, Type A

REF 203

- ◆ Outer cannula, extra-long, fenestrated
- ◆ Inner cannula, fenestrated, with slide-on silver valve type A
- ◆ Inner cannula
- ◆ Wide neck strap (shown below)

For tracheostomised patients with fully or partially intact larynx for speaking or with tracheal stenosis.



REF 203-O:

Product variant of REF 203 with additional oxygen supply port attached to the inner cannula with speaking valve.



Extra-Long Tube, Fenestrated, with Swivel Speaking Valve, Type B

REF 204

- ◆ Outer cannula, extra-long, fenestrated
- ◆ Inner cannula, fenestrated, with swivel valve type B
- ◆ Inner cannula
- ◆ Wide neck strap (shown below)

For tracheostomised patients with fully or partially intact larynx for speaking or with tracheal stenosis.



REF 204-O:

Product variant of REF 204 with additional oxygen supply port attached to the inner cannula with speaking valve



**Tubes of size 13 and 14 are made to order.
Delivery time is approx. 10 working days.**



Accessory for TRACOE comfort Tubes:

- ◆ Speaking valves, artificial noses and occlusion caps (for details see page 60 and 61).



Each TRACOE comfort tube is supplied with

an adjustable neck strap and a tube info card with peel-off stickers on front and back. The neck strap is also available separately (REF 903-F).





REF 204-A



REF 214



Extra-Long Tube, Fenestrated, with Swivel Speaking Valve, Type B

REF 204-A

- ◆ Outer cannula, extra-long, fenestrated
- ◆ Inner cannula, fenestrated, with swivel valve type B
- ◆ Inner cannula with 15 mm connector
- ◆ Inner cannula
- ◆ Wide neck strap (shown on page 53)

For tracheostomised patients with fully or partially intact larynx for speaking or with tracheal stenosis.



REF 204-A-O:

Product variant of REF 204-A with additional oxygen supply port attached to the inner cannula with speaking valve.



Product variants:

Product variants can be made in order to optimise the functionality and wearing comfort and also for patients with complex anatomical and physiological conditions.

Extra-Long Tube, Fenestrated, with Swivel Speaking Valve, Type B

REF 214

- ◆ Outer cannula, extra-long, fenestrated
- ◆ Inner cannula, fenestrated, with swivel valve type B
- ◆ Inner cannula with 15 mm connector
- ◆ Wide neck strap (shown on page 53)

For tracheostomised patients with fully or partially intact larynx for speaking or with tracheal stenosis.

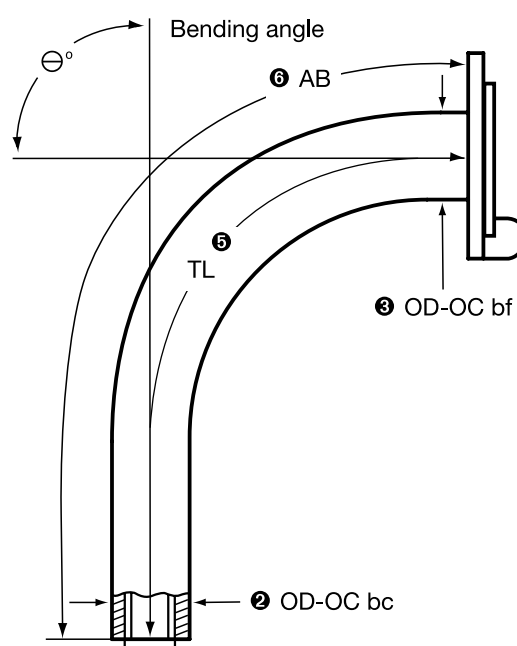



REF 205

Extra-Long Tube with 15 mm Connector

REF 205

- ◆ Outer cannula, extra-long
- ◆ Inner cannula with 15 mm connector
- ◆ Wide neck strap (shown on page 53)

For attaching:

TRACOE humid assist I (REF 640-CT),
TRACOE humid assist III (REF 641) and
TRACOE humid assist IV (REF 642).

Further information see page 58 to 61.



REF 215



Extra-Long Tube, Fenestrated, with 15 mm Connector

REF 215

- ◆ Outer cannula, extra-long, fenestrated
- ◆ Inner cannula, fenestrated, with 15 mm connector
- ◆ Inner cannula with 15 mm connector
- ◆ Wide neck strap (shown on page 53)

For attaching:

TRACOE phon assist (e.g. REF 650-T) and
TRACOE humid assist (e.g. REF 640-CT).

Further information see page 58 to 61.

Reference Numbers and Measurements: REF 214 and REF 215

| Size | ❶ | ❷ | ❸ | ❹ | Lengths (mm) | |
|------|---------------|------------------|------------------|---------------|--------------|------|
| | ID-OC (mm) | OD-OC bc (mm) | OD-OC bf (mm) | ID-IC (mm) | ❺ TL | ❻ AB |
| 07 | 7.0 | 8.8 | 10.5 | 5.8 | 57 | 65 |
| 08 | 8.0 | 10.0 | 11.3 | 6.8 | 61 | 70 |
| 09 | 9.0 | 11.4 | 12.6 | 7.6 | 65 | 75 |

❶ ID-OC: inside diameter (clear width) at bottom of outer cannula; ❷ OD-OC bc: outside diameter at bottom of outer cannula; ❸ OD-OC bf: outside diameter of outer cannula behind the flange; ❹ ID-IC: inside diameter at bottom of inner cannula; ❺ Length TL: length along centre line from start of neck flange to bottom of tube; ❻ Length AB: length along outer bend (greatest length)

⦿ The bending angle is 90° in *comfort* tubes.

► To order, specify: REF + size (e.g. REF 214-07).





Flexibility

Speaking valves, artificial noses and occlusion possibilities for a variety of tracheostomy tubes and other carriers.



TRACOE[®]

modular

NEW PRODUCT GROUP!

The Modular System

TRACOE speaking valves and heat/moisture exchanger can be attached to different support systems with 15mm connectors or 22mm housings, depending on requirements and indications. This modular system for tracheostomy tubes, stoma buttons, short tubes and adhesive carriers permits flexible solutions to suit individual patients.

Speaking Valves

TRACOE phon assist I is used by tracheostomised patients and offers, due to the infinitely adaptable airway resistance, new therapeutic options. The TRACOE phon assist II speaking valve makes it possible for laryngectomised patients with a voice prosthesis and tracheostomised patients to speak hands-free. Both versions are individually adjustable.

Heat/Moisture Exchangers

TRACOE humid assist I to IV are heat/moisture exchangers (HMEs) that act like an artificial nose by warming, moistening and filtering inhaled air.



For Tracheostomy Tubes

Speaking Valves

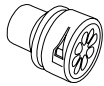

phon assist I
REF 650-T

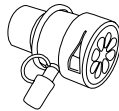

**phon assist I with
oxygen supply port**
REF 650-TO

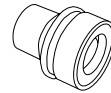

phon assist II
REF 655-T

Heat/moisture exchanger (HMEs)

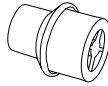

humid assist I
REF 640-CT



humid assist II
REF 645

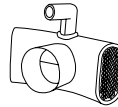

humid assist III
REF 641

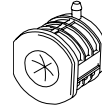

humid assist IV
REF 642

Possible Combinations

Occlusion Cap
REF 516



Tubes, fenestrated

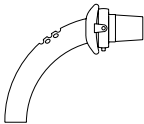

● **TRACOE *twist* and *twist plus* tubes, fenestrated, with 15 mm connector**
REF 302, REF 302-P, REF 304,
REF 888-306, REF 888-306-P,
REF 312, REF 312-P, REF 314,
REF 888-316, REF 888-316-P

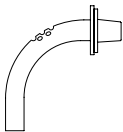

● **TRACOE *comfort* tube, fenestrated, with 15 mm connector**
REF 115, REF 215

Each in combination with:

- ◀ **phon assist I** (REF 650-T)
- ◀ **phon assist I with oxygen supply port** (REF 650-TO)
- ◀ **humid assist I** (REF 640-CT)
- ◀ **humid assist III** (REF 641)
- ◀ **humid assist IV** (REF 642)
- ◀ **phon assist II** (REF 655-T)
- ◀ **phon assist II (REF 655-T) + humid assist II** (REF 645)
- ◀ **Occlusion Cap** (REF 516)

Tubes, unfenestrated

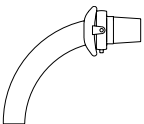

● **TRACOE *twist* and *twist plus* tubes, with 15 mm connector**
REF 301, REF 301-P, REF 303,
REF 305, REF 306, REF 309, REF 311,
REF 311-P, REF 313, REF 316

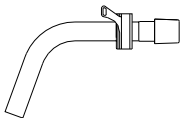

● **TRACOE *vario* tubes, with 15 mm connector**
REF 450, REF 450-P, REF 451, REF 451-P, REF 455,
REF 460, REF 460-P, REF 461, REF 461-P, REF 470,
REF 470-P, REF 471, REF 471-P

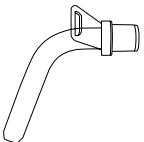

● **TRACOE *pure* tube, with 15 mm connector**
REF 480

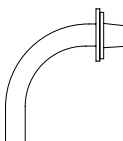

● **TRACOE *comfort* tubes, with 15 mm connector**
REF 103-A, REF 104-A, REF 114, REF 105,
REF 105-D, REF 204-A, REF 205, REF 214

Each in combination with:

- ◀ **humid assist I** (REF 640-CT)
- ◀ **humid assist III** (REF 641)
- ◀ **humid assist IV** (REF 642)



Caution: All tubes with cuff have to be deflated before using a speaking valve!

For TRACOE buttons, Silicone Short Tubes and Adhesive Carriers

Speaking Valves

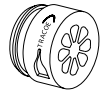

phon assist I
REF 650-S

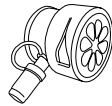

**phon assist I with
oxygen supply port**
REF 650-SO



phon assist II
REF 655-S

Heat/moisture exchanger (HMEs)

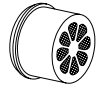

humid assist I
REF 640-S



humid assist II
REF 645

Stopper
REF 621



Possible Combinations

Carrier with 22 mm housings

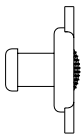

● **TRACOE larynx grid button**
REF 601, REF 602, REF 603



● **TRACOE larynx stoma button**
REF 611, REF 612, REF 613

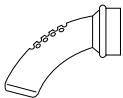

● **TRACOE larynx Silicone Short Tube,
fenestrated**
REF 581, REF 583



● **TRACOE larynx Adhesive Carrier**
REF 660, REF 661

Each in combination with:

- ◀ **phon assist I** (REF 650-S)
- ◀ **phon assist I with oxygen supply port** (REF 650-SO)
- ◀ **humid assist I** (REF 640-S)
- ◀ **phon assist II** (REF 655-S)
- ◀ **phon assist II** (REF 655-S) + **humid assist II** (REF 645)
- ◀ **Stopper** (REF 621)

NEW!

NEW!

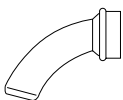

● **TRACOE larynx Silicone Short Tube**
REF 580, REF 582

Each in combination with:

- ◀ **humid assist I** (REF 640-S)



Speaking Valves and Occlusion Caps For Tracheostomy Tubes

REF 650-T



REF 655-T



REF 650-TO



REF 516



TRACOE phon assist I

REF 650-T 1 unit supplied in sterile package
Speaking valve with air supply from the side, infinitely adjustable, for attachment to any fenestrated tube with 15 mm connector (page 22/23, e.g. REF 302 and REF 304).
Air supply from the side allows an individually adjustable airway resistance.
Fits all tube sizes.

TRACOE phon assist I with Oxygen Supply Port

REF 650-TO 1 unit
supplied in sterile package

REF 650-TO-5 **NEW!** 5 units
supplied in sterile package

Speaking valve with air supply from the side, infinitely adjustable, with oxygen supply port. For attachment to any fenestrated tube with 15 mm connector (page 22/23, e.g. REF 302 and REF 304).
Air supply from the side allows an individually adjustable airway resistance.
Fits all tube sizes.

TRACOE phon assist II

REF 655-T 1 unit supplied in sterile package plus
5 units TRACOE humid assist II (REF 645),
individually packaged in cleanroom
Hands-free speaking valve, infinitely adjustable, for attachment to any fenestrated tube with 15 mm connector (page 22/23, e.g. REF 302 and REF 304).
Fits all tube sizes.

Occlusion Caps for 15 mm Connectors (blue)

REF 516 5 units, sterile,
individually packaged
Occlusion caps for fenestrated tubes with 15 mm connector.



Scope of delivery of speaking valves and occlusion caps includes a product info card with peel-off stickers on front and back.

Heat/Moisture Exchanger, HME For Tracheostomy Tubes

REF 640-CT



REF 642



REF 641



REF 645



TRACOE humid assist I

REF 640-CT 50 units,
individually packaged in cleanroom
Heat/moisture exchanger for attachment to any tube
with 15 mm connector.
Fits all tube sizes.

TRACOE humid assist III

REF 641 50 units, sterile,
individually packaged
Heat/moisture exchanger with paper filter for attach-
ment to any tube with 15 mm connector, integrated
oxygen supply port, turnable through 360°.
Fits all tube sizes.

TRACOE humid assist IV

REF 642 30 units,
individually packaged in cleanroom
Heat/moisture exchanger for attachment to any tube
with 15 mm connector, integrated oxygen supply port
and pressure control valve for expectoration of larger
quantities of secretion.
Fits all tube sizes.

TRACOE humid assist II

REF 645 50 units individually
packaged in cleanroom
Heat/moisture exchanger for attaching to the hands-
free speaking valve TRACOE phon assist II (REF 655-T).



Speaking Valves and Stopper

For TRACOE buttons, Silicone Short Tubes and Adhesive Carriers

REF 650-S



REF 655-S



REF 650-SO



REF 621



TRACOE phon assist I

REF 650-S 1 unit supplied in sterile package
Speaking valve with air supply from the side, infinitely adjustable, with flat base.

For insertion in TRACOE stoma and grid buttons (REF 601-603 and REF 611-613), TRACOE adhesive carriers (REF 660 and REF 661) and silicone short tubes (REF 580-583).

Air supply from the side allows an individually adjustable airway resistance.

Caution:

Not for use by laryngectomised patients.

TRACOE phon assist I with Oxygen Supply Port

REF 650-SO 1 unit supplied in sterile package
Speaking valve, infinitely adjustable, with flat base, oxygen supply port and cap.

For insertion in TRACOE stoma and grid buttons (REF 601-603 and REF 611-613), TRACOE adhesive carriers (REF 660 and REF 661) and silicone short tubes (REF 580-583).

Air supply from the side allows an individually adjustable airway resistance.

Caution:

Not for use by laryngectomised patients.

TRACOE phon assist II

REF 655-S 1 unit supplied in sterile package plus
5 units TRACOE humid assist II (REF 645),
individually packaged in cleanroom

Hands-free speaking valve, infinitely adjustable, for attachment to TRACOE stoma and grid buttons (REF 601-603 and REF 611-613), TRACOE adhesive carriers (REF 660, REF 661) and silicone short tubes (REF 580-583). Fits all sizes.

Caution:

After laryngectomy only to be used in conjunction with a voice prosthesis!

Stopper

REF 621 5 units supplied in sterile package
To temporarily seal TRACOE stoma and grid buttons (REF 601-603 and REF 611-613), TRACOE adhesive carriers (REF 660, REF 661) and silicone short tubes (REF 580-583) in patients with unobstructed upper airways and unrestricted breathing.

Caution:

Not for use by laryngectomised patients.

Heat/Moisture Exchanger, HME

For TRACOE buttons, Silicone Short Tubes and Adhesive Carriers

REF 640-S



REF 645



TRACOE humid assist I

REF 640-S 50 units individually
packaged in cleanroom

Heat/moisture exchanger with flat base for all carriers with 22 mm housing, e.g. TRACOE stoma and grid buttons (REF 601-603 and REF 611-613), TRACOE adhesive carriers (REF 660 and REF 661) and silicone short tubes (REF 580-583).

For patients with or without voice prosthesis.

TRACOE humid assist II

REF 645 50 units individually
packaged in cleanroom

Heat/moisture exchanger for attaching to the hands-free speaking valve TRACOE phon assist II (REF 655-S).



Scope of delivery of speaking valves and stopper includes a product info card with peel-off stickers on front and back.





Under Control

Cuff Pressure Monitoring:
Spot measurements with
a handheld manometer or
continuous, fully automatic
monitoring and control.
Prevents complications and
secondary problems for
the patient.

TRACOE®

technic

Cuff Pressure Management

TRACOE *technic* refers to medical devices, which allow setting and control of pressure in low pressure cuffs of tracheostomy and endotracheal tubes with high precision.

Constant Pressure

Why is it so important for the cuff to be properly inflated? For one, to ensure sufficient ventilation at all times. For another, to prevent silent aspiration, which, under certain circumstances, can lead to a nosocomial ventilation pneumonia. It also prevents damage to the trachea (mucosal necrosis, destruction of cartilage, tracheomalacia).

Two Systems, One Goal

TRACOE *technic* includes two ways to regularly check the cuff pressure. First, the TRACOE cpm handheld manometer, featuring a large, easy-to-read scale (0-100 cmH₂O) for quick and easy measurements. The usual pressure range for the application is coloured green.

Second, the fully automatic TRACOE cpc cuff pressure control. It continuously monitors and regulates the pressure in the low pressure cuffs of tracheostomy and endotracheal tubes. Visual and audible alarms warn of leaks or overpressure. TRACOE cpc is compact and lightweight, straightforward and practical to use. It reduces the workload of hospital nursing staff and the cuff pressure is 100 % securely monitored and regulated.





REF 701

TRACOE cuff pressure control

REF 701

- ◆ TRACOE cuff pressure control
- ◆ Transformer
- ◆ 3 connection tubes with integrated hydrophobic bacteria filter, each one in sterile package, length: 2 m
- ◆ 1 TRACOE *twist* tracheostomy tube with low pressure cuff

A fully automatic, precision device for continuous monitoring and control of the pressure in the low pressure cuffs of tracheostomy and endotracheal tubes.

The device contains a sensor-controlled pump for long-term, precise control of low pressure cuffs. It is powered via a transformer or, during patient transport, by a rechargeable battery (for up to 8 hours). Through a mount on the back of the instrument it can be easily attached to an intensive-care bed, stand or operating table.

The device is CE-certified and EMC-tested.

Technical Data on REF 701

| | |
|--------------------------------------|---|
| Classification | Medical-technical device, Class IIB, active, with measuring and control function |
| Power supply | 12V |
| Protection rating | II |
| Operating voltage Micro Processor | 5V |
| Power consumption | Idling (pump off, valves off): 0.08W Full power (pump and valves active): 0.65W |
| Battery | 9V, 150mAh for NiCd and 9V, 170mAh for NiMH |
| Battery display | graphic (empty, weak, medium, full) |
| Battery operating time | 8 hours |
| Battery charging time | 6-8 hours |
| Pressure display | digital |
| Control range | 5 to 100mbar |
| Control precision | ± 1mbar over the entire control range |
| Pressure display precision | ± 1 mbar |
| Max. internal cuff pressure | 100mbar |
| Maximum vacuum | - 250mbar |
| Alarm functions | Audible and visible signal: ◆ if the pressure cannot be compensated within 10 seconds ◆ in the event of leakages ◆ in case of a pressure increase of > 100mbar ◆ if the battery is almost flat ◆ if the mains connector is unplugged or there is a power failure |
| Pneumatic device connection | Bayonet connector |
| Device dimensions | Height: 100mm, width: 150mm, depth: 60mm |
| Weight | 350g (incl. battery) |

TRACOE Power Pack (REF 704)

| | |
|-------------------|-------------------|
| Power supply | 100-240V, 50-60Hz |
| Protection rating | II |

Ambient Conditions

| | |
|----------------------|---|
| Storage conditions | Temperature -40 to +70°C, relative air humidity 10-95 % |
| Operating conditions | Temperature 10 to +70°C, relative air humidity 10-95 % Altitude up to 3.000 m (NN) |



REF 720

NEW: WITH HOOK!



REF 702



REF 703



REF 703-A

TRACOE cuff pressure monitor

REF 720

- ◆ TRACOE cuff pressure monitor
- ◆ 1 connection tube REF 702

The TRACOE cuff pressure monitor is used to fill and monitor the pressure of high-volume, low pressure cuffs of tracheostomy and endotracheal tubes.

Its outstanding features and benefits:

- ◆ Easy use
- ◆ Precise, reproducible pressure indication
- ◆ Extra-large, easy-to-read scale from 0-100 cmH₂O
- ◆ Widely spaced scale markings with colour coded pressure ranges

The TRACOE cuff pressure monitor comes with a connection tube with male and female Luer lock connectors on its ends (REF 702).

Connection Tubes

for REF 720, TRACOE cuff pressure monitor:

REF 702

10 units supplied in individual sterile packages

Tube for connecting a tracheostomy or endotracheal tube. With Luer lock connectors. Length 1 m

REF 703

10 units supplied in individual sterile packages

Tube for connecting a tracheostomy or endotracheal tube. With Luer lock connectors. Length: 2 m

for REF 701, TRACOE cuff pressure control:

REF 703-A

10 units supplied in individual sterile packages

Connecting tube with integrated hydrophobic bacteria filter for connecting a tracheostomy or endotracheal tube. With bayonet and Luer lock connectors. Length: 2 m



***Soft, Lightweight,
Transparent:***

TRACOE buttons, silicone short tubes and adhesive carriers. An alternative for tracheostomised and laryngectomised patients.

TRACOE[®]

larynx

Individual Solutions

TRACOE *larynx* is a product group that is specifically geared to meet the needs of laryngectomised and tracheostomised patients in the hospital, during rehabilitation and homecare.

The Products

TRACOE stoma buttons and short tubes are made of soft, flexible silicone. Developed for patients who only require a device to keep the tracheostoma open continuously and do not need a proper tracheostomy tube, and for attaching speaking valves and/or HMEs.

The TRACOE adhesive carriers for laryngectomised or tracheostomised patients to attach heat/moisture exchangers (HMEs) humid assist I or the speaking valves phon assist I and phon assist II.

Information and reference numbers for TRACOE heat/moisture exchangers as well as TRACOE speaking valves you will find in the **NEW PRODUCT GROUP** TRACOE *modular* as from page 56 onwards.

Possible Combinations with TRACOE *modular*

Carrier with 22 mm housing

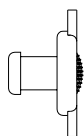

- TRACOE *larynx* grid button
REF 601, REF 602, REF 603



- TRACOE *larynx* stoma button
REF 611, REF 612, REF 613

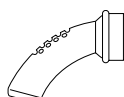

- TRACOE *larynx* Silicone Short Tube, fenestrated
REF 581, REF 583



- TRACOE *larynx* Adhesive Carrier
REF 660, REF 661

Each in combination with:

- ◀ phon assist I (REF 650-S)
- ◀ phon assist I with oxygen supply port (REF 650-SO)
- ◀ humid assist I (REF 640-S)
- ◀ phon assist II (REF 655-S)
- ◀ phon assist II (REF 655-S) + humid assist II (REF 645)
- ◀ Stopper (REF 621)

NEW!

NEW!

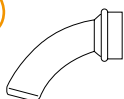

- TRACOE *larynx* Silicone Short Tube
REF 580, REF 582

In combination with:

- ◀ humid assist I (REF 640-S)



Pictures, reference numbers and information for heat/moisture exchangers (humid assist), speaking valves (phon assist) and stoppers you will find in the **NEW PRODUCT GROUP** TRACOE *modular* as from page 56 onwards.



TRACOE *larynx* – stoma buttons

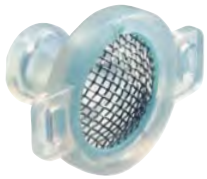

REF 601
Short



REF 602
Standard



REF 603
Long



REF 611
Short



REF 612
Standard



REF 613
Long



TRACOE grid button

REF 601/REF 602/REF 603

1 unit supplied in sterile package
with 1 neck strap

stoma button with eyes for attaching a neck strap and
with a removable grid to prevent inhalation of foreign
objects.

Sizes: 06, 07, 08, 09, 10, 11, 12

TRACOE stoma button

REF 611/REF 612/REF 613

1 unit supplied in sterile package

Sizes: 06, 07, 08, 09, 10, 11, 12

Reference Numbers and Measurements: REF 601 to REF 603 and REF 611 to REF 613

| Size | ID (mm) | OD (mm) | REF 601 REF 611 | REF 602 REF 612 | REF 603 REF 613 |
|--|------------|------------|--------------------|--------------------|--------------------|
| | | | Short | Standard | Long |
| | | | Length (mm) | Length (mm) | Length (FR) |
| 06 | 6 | 9 | 16 | 22 | 30 |
| 07 | 7 | 10 | 16 | 22 | 30 |
| 08 | 8 | 11 | 16 | 22 | 30 |
| 09 | 9 | 12 | 16 | 22 | 30 |
| 10 | 10 | 13 | 16 | 22 | 30 |
| 11 | 11 | 14 | 16 | 22 | 30 |
| 12 | 12 | 15 | 16 | 22 | 30 |
| ID: inside diameter; OD: outside diameter; L: length | | | | | |
| ► To order, specify: REF + size (e.g. REF 601-06). | | | | | |



Scope of delivery TRACOE *larynx* products (except
adhesive carriers) includes a product info card with
peel-off stickers on front and back.

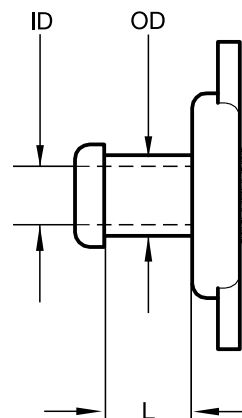

TRACOE *larynx* – Silicone Short Tubes



REF 580

REF 582

NEW!



REF 581

REF 583



NEW!



REF 585

REF 586

NEW!

TRACOE Silicone Short Tube with Connector, Unfenestrated

REF 580 Length 36 mm 1 unit, supplied with neck strap

REF 582 Length 53 mm 1 unit, supplied with neck strap

Ideal for the use in stable tracheostomas to secure the respiratory tracts once no tracheostomy tube is needed anymore.

For attachment to TRACOE humid assist I (REF 640-S).

TRACOE Silicone Short Tube with Connector, Fenestrated

REF 581 Length 36 mm 1 unit, supplied with neck strap

REF 583 Length 53 mm 1 unit, supplied with neck strap

For tracheostomised and laryngectomised patients with a voice prosthesis.

For attachment to TRACOE phon assist I (REF 650-S), TRACOE phon assist I with oxygen supply port (REF 650-SO), TRACOE phon assist II (REF 655-S) with or without TRACOE humid assist II (REF 645) and TRACOE humid assist I (REF 640-S).

TRACOE Silicone Short Tube without Connector

REF 585 Length 36 mm 1 unit, supplied with neck strap

REF 586 Length 53 mm 1 unit, supplied with neck strap

Ideal for the use in stable tracheostomas to secure the respiratory tracts once no tracheostomy tube is needed anymore.

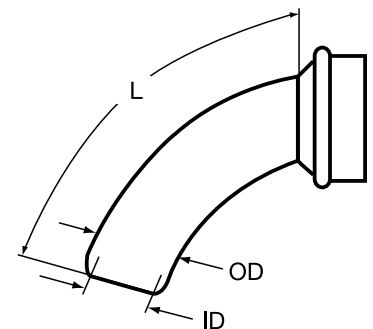

Reference Numbers and Measurements: REF 580, REF 581, REF 585 and REF 582, REF 583, REF 586

| Size | ID (mm) | OD (mm) | REF 580 REF 581 REF 585 | REF 582 REF 583 REF 586 |
|--|---------|---------|-------------------------------|-------------------------------|
| | | | Length (mm) | Length (mm) |
| 08 | 9.5 | 12.0 | 36 | 53 |
| 09 | 10.5 | 13.5 | 36 | 53 |
| 10 | 12.5 | 15.0 | 36 | 53 |
| 12 | 13.5 | 17.0 | 36 | 53 |
| ID: inside diameter; OD: outside diameter; L: length | | | | |
| ► To order, specify: REF + size (e.g. REF 580-09). | | | | |

TRACOE *larynx* – button plus and Adhesive Carriers

REF 660



REF 661



REF 607-70

NEW!



REF 607-45

NEW!

TRACOE Adhesive Carrier Hydrocolloid

REF 660 20 units, individually packaged

For affixing onto the tracheostoma.

With an allergenic hydrocolloid coating, particularly suitable for patients with sensitive skin.

Includes support ring for TRACOE speaking valves phon assist I (REF 650-S and REF 650-SO) and phon assist II (REF 655-S) with or without a heat/moisture exchanger TRACOE humid assist II (REF 645) and Stopper REF 621.

TRACOE Adhesive Carrier Standard

REF 661 20 units, individually packaged

For affixing onto the tracheostoma.

The adhesive carrier is particularly thin and coated with a strong acrylate adhesive.

Includes support ring for TRACOE speaking valve phon assist I (REF 650-S and REF 650-SO) and phon assist II (REF 655-S) with or without HME TRACOE humid assist II (REF 645), TRACOE humid assist I (REF 640-S) and Stopper REF 621.

TRACOE button plus

REF 607-70 Length 70 mm 1 unit, supplied with neck strap

REF 607-45 Length 45 mm 1 unit, supplied with neck strap

For the therapy of tracheostomised patients after long-term ventilation – safe airway after decannulation. The sealing is very airtight and dislocation save. The patient is able to cough up the stimulus secretion very fast. With the adjustable neck flange the TRACOE button plus can be positioned optimal to the soft neck tissue. Inside diameter 8.0 mm, Outside diameter 10.5 mm

Caution, not suitable for



- ◆ laryngectomised patients
- ◆ patients with unstable breathing,
- ◆ patients, who primarily breathe through the tracheostoma.





Cleaning, Maintenance, Accessories

Optimally designed to facilitate the daily use of TRACOE products. Practical and convenient for patients and health-care staff.



TRACOE[®]

care

Tracheostoma-Management – As Comfortable as Possible

Special situations require special solutions. Tracheostomised and laryngectomised patients need accessories that help make daily life with a tracheostomy tube as comfortable as possible. Many products in the TRACOE *care* line of accessories enhance the daily use of tracheostomy tubes, such as neck straps, protective scarves and spacers. The special cleaning kits and tracheal compresses ensure proper hygiene, which is of utmost importance.

Product Location Service

You cannot find a specific product in the extensive TRACOE *care* range? Call them! The team of TRACOE medical will assist you in locating the required accessory.





Neck Straps

For holding tubes securely in place.

| REF | max. length (approx.) in cm | Width of neck strap (approx.) in cm |
|-------|--------------------------------|--|
| 903-A | 44 | 1.5 |
| 903-B | 47 | 2.5 |
| 903-D | 48 | 2.5 |
| 903-E | 49 | 4.0 |
| 903-F | 43 | 2.5 |
| 903-G | 31 | 2.5 |
| 903-H | 39 | 2.5 |
| 903-I | 48 | 2.5 |
| 903-J | 36 | 2.5 |

REF 903-A 1 unit

REF 903-B 1 unit

REF 903-B-P 10 units

REF 903-D 1 unit

REF 903-E 1 unit

REF 903-E-P 10 units

REF 903-F 1 unit

REF 903-F-P 10 units

REF 903-G 1 unit



REF 903-H 1 unit

REF 903-H-P 10 units

REF 903-I 1 unit

REF 903-I-P 10 units

REF 903-J 1 unit

REF 903-J-P 10 units

Beige, elastic, with hook

White, wide, padded,
with hook-and-loop fastener

Identical to REF 903-B

White, wide, elastic,
with hook-and-loop fastener,
individually adjustable

White, wide,
with hook-and-loop fastener

Identical to REF 903-E

White, wide, consists of two
parts, adjustable length,
with hook-and-loop fastener
Identical to REF 903-F

White, wide, consists of two
parts, adjustable length,
with hook-and-loop fastener,
for neonates and children

White, wide, padded,
with hook

Identical to REF 903-H

White, long, wide, padded,
with hook

Identical to REF 903-I

White, short, wide, padded,
with hook

Identical to REF 903-J



REF 902



REF 915

Liquid Paraffin

REF 902

Lubricates and protects TRACOE *comfort* tubes.
Lets inner cannulas be easily inserted and removed,
assures best possible fit and good quality of speech.
Contents: 25 ml

Shower Guard

REF 915

Protection for tube wearers while showering.
Soft, adaptable and adjustable to different neck sizes.

Caution:

May not be used for full-body bathing or swimming!

TRACOE care – Cleaning Kits



REF 930-A

REF 930-B



REF 931-A

REF 931-B

TRACOE tube clean Cleaning Kits

For cleaning TRACOE tracheostomy tubes and TRACOE buttons.

REF 930-A With cleaning powder and small cleaning swabs

- ♦ tube clean cleaning powder (REF 932)
- ♦ tube clean cleaning tub (REF 934)
- ♦ 1 cleaning brush (REF 938-A)
- ♦ 50 cleaning swabs, small (REF 935)

REF 930-B With cleaning powder and large cleaning swabs

- ♦ tube clean cleaning powder (REF 932)
- ♦ tube clean cleaning tub (REF 934)
- ♦ 1 cleaning brush (REF 938-A)
- ♦ 50 cleaning swabs, large (REF 936)

REF 931-A With concentrated cleaning liquid and small cleaning swabs

- ♦ tube clean concentrated cleaning liquid (REF 933)
- ♦ tube clean cleaning tub (REF 934)
- ♦ 1 cleaning brush (REF 938-A)
- ♦ 50 cleaning swabs, small (REF 935)

REF 931-B With concentrated cleaning liquid and large cleaning swabs

- ♦ tube clean concentrated cleaning liquid (REF 933)
- ♦ tube clean cleaning tub (REF 934)
- ♦ 1 cleaning brush (REF 938-A)
- ♦ 50 cleaning swabs, large (REF 936)

i All articles in the cleaning kits are also available separately.

i Detailed tips and information on how to clean, disinfect and care for tracheostomy tubes can be found on pages 85 and 86 and in the respective instructions for use.



REF 933



REF 932



REF 934

TRACOE tube clean Concentrated Cleaning Liquid

REF 933 1 bottle

Liquid cleaning concentrate for cleaning tracheostomy tubes and stoma/grid buttons. Dissolves incrustations. Rapidly acting.

Contents: 250 ml (for approx. 100 applications)

TRACOE tube clean Cleaning Tub with Mesh Basket

REF 934 1 tub

For tracheostomy tubes and stoma/grid buttons. Volume: 1000 ml

TRACOE tube clean Cleaning Powder

REF 932 1 tub

Cleaning powder for cleaning tracheostomy tubes and stoma/grid buttons. Dissolves incrustations.

Contents: 400 g (for approx. 60 applications)



REF 935



REF 970



REF 936



REF 687

TRACOE tube clean Cleaning Swabs

REF 935 *Small* Pack of 50

Bendable plastic swabs with polyurethane sponge tip for cleaning tracheostomy tubes/cannulas with an inner diameter of 3 to 7 mm.

For single use.

TRACOE tube clean Cleaning Swabs

REF 936 *Large* Pack of 50

Bendable plastic swabs with polyurethane sponge tip for cleaning tracheostomy tubes/cannulas with an inner diameter of 8 to 14 mm.

For single use.

Protective Skin Cloth

REF 970 Pack of 50

For daily skin care and cleaning around the tracheostoma. Dermatologically tested, bactericidal, antiseptic, and itch-reducing. Impregnated with lipid regulating substances.

Angled Forceps

REF 687 1 unit

To remove incrustations and clean tubes. Made of stainless steel, autoclaveable.



REF 938

REF 939

REF 940

REF 941

TRACOE Cleaning Brushes with Wool Tip

REF 938

Pack of 10

Angled brush with extra-soft nylon bristles for removing incrustations. To reduce scratching, the brushes have a wool tip.

| REF | Bristle-diameter | For tube inside diameter | Approx. total length |
|--------------|------------------|--------------------------|----------------------|
| 938-A | 7 mm | 5/6 mm | 21 cm |
| 938-B | 9 mm | 7/8 mm | 21 cm |
| 938-C | 11 mm | 9/10 mm | 21 cm |

TRACOE Cleaning Brushes with Wool Tip in a Kit of 5 in Different Sizes

REF 939

The kit contains:

KIT OF 5

| Quantity | Bristle-diameter | For tube inside diameter | Approx. total length |
|----------|------------------|--------------------------|----------------------|
| 1 unit | 7 mm | 5/6 mm | 21 cm |
| 2 units | 9 mm | 7/8 mm | 21 cm |
| 2 units | 11 mm | 9/10 mm | 21 cm |

TRACOE Cleaning Brushes for Flexible Tracheostomy Tubes

REF 940

Pack of 10

Extra-long, specially made for cleaning flexible tracheostomy tubes. The wire used has a rounded tip and the bristles are made of soft nylon.

| REF | Bristle-diameter | For tube inside diameter | Approx. total length. |
|--------------|------------------|--------------------------|-----------------------|
| 940-A | 7 mm | 5/6 mm | 31.5 cm |
| 940-B | 9 mm | 7/8 mm | 33.5 cm |
| 940-C | 11 mm | 9/10 mm | 36.0 cm |
| 940-D | 13 mm | 11/12 mm | 36.0 cm |

TRACOE Cleaning Brushes for Flexible Tracheostomy Tubes in a Kit of 10 in Different Sizes

REF 941

The kit contains:

KIT OF 10

| Quantity | Bristle-diameter | For tube inside diameter | Approx. total length |
|----------|------------------|--------------------------|----------------------|
| 2 units | 7 mm | 5/6 mm | 31.5 cm |
| 2 units | 9 mm | 7/8 mm | 33.5 cm |
| 3 units | 11 mm | 9/10 mm | 36.0 cm |
| 3 units | 13 mm | 11/12 mm | 36.0 cm |

TRACOE care – Tracheal Compresses, Nonsterile

REF 905



REF 909

REF 908



REF 910-A

REF 910-B



REF 960



Tracheal Compresses, Aluminium Coated with Zigzag Slit

REF 905

Pack of 10

Tracheal compresses, aluminium coated, avoid the compress sticking to the wound or the skin. They absorb secretions between the stoma and the tube. Dimensions: approx. 9 x 9.8 cm

TRACOE Tracheostoma Protection

REF 908

Small

Pack of 10

Dimensions: approx. 6 x 6.5 cm

REF 909

Large

Pack of 10

Dimensions: approx. 7.2 x 7.2 cm

Prevents foreign objects from entering the tracheostoma. With adhesive strip, for single use, for adults and children.

Tracheal Compresses

REF 910-A

Without slit

Pack of 10

REF 910-B

With zigzag slit

Pack of 10

These tracheal compresses absorb secretions from the tracheostoma to avoid skin irritations.

Dimensions: approx. 9 x 9.8 cm

Coated Tracheal Compresses with Zigzag Slit

REF 960

Pack of 10

To absorb secretions from the tracheostoma to avoid skin irritations. The coating further avoids the absorbant compress sticking to the wound or the skin. Dimensions: approx. 8 x 10 cm



The zigzag slit keeps the compresses securely in place. At the same time it is quite simple to remove the compress and replace it with a new one whilst wearing the tracheostomy tube.

REF 907-A

REF 907-B



REF 957



REF 912



REF 961



Two-Ply Tracheal Compresses

REF 907-A *Without slit* *Pack of 10*

REF 907-B *With zigzag slit* *Pack of 10*

Two-ply tracheal compresses absorb a large amount of secretions from the tracheostoma quickly to avoid skin irritations. At the same time they are used as a pad between the tracheostoma and the tracheostomy tube. Dimensions: approx. 9 x 9.8 cm

Fleece Tracheal Compresses

REF 912 *Pack of 100*

Fluff-free, 4-ply fleece tracheal compresses.

Dimensions: approx. 10 x 10 cm

Coated Two-Ply Tracheal Compresses with Zigzag Slit

REF 957 *Pack of 10*

Two-ply tracheal compresses absorb a large amount of secretions from the tracheostoma quickly to avoid skin irritations. The absorbent coating further avoids the compress sticking to the wound or skin.

At the same time they are used as a pad between the tracheostoma and the tracheostomy tube.

Dimensions: approx. 8 x 10 cm



Tracheal Compresses with Zigzag Slit for Neonates and Children

REF 961 *Pack of 10*

Tracheal compresses to absorb secretions from the tracheostoma to avoid skin irritations. At the same time they are used as a pad and a protection for the sensitive skin around the tracheostoma.

The compresses are ideally adapted to the anatomy of neonates and children.

Dimensions: approx. 6.5 x 6.3 cm

TRACOE care – Sterile Tracheostomy Dressing

REF 958



REF 959



REF 969



TRACOE purofoam Tracheostomy Dressing



The TRACOE purofoam tracheostomy dressings are made of highly absorbent open pore polyurethane foam (a). The foam has a non-sticking layer (b) on the side facing the tracheostoma which allows quick absorption of liquids into the foam's core. The opposite side is covered with a skin coloured, vapour permeable coating which will prevent leakage of secretions and bacteria through the front of the dressing (c).

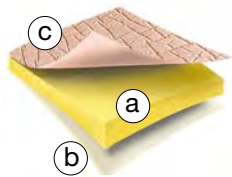

Due to the circular opening and the zigzag slit the dressing can be easily replaced with a new one whilst wearing the tracheostomy tube. As the dressing does not stick to the skin, it can be removed and replaced without causing trauma or pain.

The TRACOE purofoam tracheostomy dressing can be used to dress a newly established or an existing, irritated tracheostoma, as well as healed but weeping tracheostomas and any other kind of artificial orifice. This dressing meets modern standards of moist wound treatment.

REF 958

Large

Pack of 10 supplied in individual sterile packages

For tracheostomy tube sizes 06 to 12.
Dimensions: approx. 9 x 10 x 0.5 cm

REF 959

Small

Pack of 10 supplied in individual sterile packages

For tracheostomy tube sizes 03 to 05.
Dimensions: approx. 6.5 x 6.5 x 0.5 cm

TRACOE softpad Tracheostomy Stoma Pads

REF 969

Pack of 20 supplied in individual sterile packages

Oval tracheostomy stoma pads made of open-pored, highly absorbent polyurethane foam. Avoids decubitus, compensates unevenness due to scars, seals air leaks (function of speech).

Dimensions: oval, approx. 5.5 cm at longest point and approx. 3.7 cm at widest point.



REF 919

REF 920



REF 921



REF 923

TRACOE Protective Bibs

| | | | |
|-----------|--------|-------|--------|
| REF 919-A | 3-ply | White | 1 unit |
| REF 919-B | 6-ply | | 1 unit |
| REF 919-C | 12-ply | | 1 unit |
| REF 920-A | 3-ply | Beige | 1 unit |
| REF 920-B | 6-ply | | 1 unit |
| REF 920-C | 12-ply | | 1 unit |

The protective bibs filter and warm the respiratory air. At the same time they protect clothes from possible secretions. Made of polyester, with continuously adjustable hook-and-loop fastener.

TRACOE Protective Scarves

| | | | |
|-----------|-------------|--|--------|
| REF 921-A | Grey plaid | | 1 unit |
| REF 921-B | Beige plaid | | 1 unit |
| REF 921-C | Dark green | | 1 unit |
| REF 921-D | Dark blue | | 1 unit |
| REF 921-E | Burgundy | | 1 unit |

Made of 100% viscose with integrated polyester layer. The TRACOE protective scarves are worn around the neck like an average scarf and are secured with an continuously adjustable hook-and-loop fastener.

TRACOE Protective Roll-Necks

REF 923 *Fine knit* *Classically elegant*

| | | | |
|-----------|------------|--|--------|
| REF 923-A | White | | 1 unit |
| REF 923-B | Gray | | 1 unit |
| REF 923-C | Beige | | 1 unit |
| REF 923-D | Dark green | | 1 unit |
| REF 923-E | Dark blue | | 1 unit |
| REF 923-F | Burgundy | | 1 unit |
| REF 923-G | Black | | 1 unit |

TRACOE protective roll-necks are made of 100% cotton with an integrated polyester layer. They are worn underneath the shirt.



Washing Instructions for TRACOE Protective Bibs, TRACOE Protective Scarves and TRACOE Protective Roll-Necks:

- ◆ Hand-wash, 30°C, with mild soap
- ◆ No dry-cleaning
- ◆ No bleaching
- ◆ No ironing

INFORMATION FOR PATIENTS

Tips for Everyday Use of TRACOE Tracheostomy Tubes

Cleaning and Maintenance

The easiest way to clean the tubes is to use the TRACOE tube clean cleaning kits (REF 930-A/-B or REF 931-A/-B), developed especially for this purpose. Never use a strong household cleaning product, a denture cleanser, or strong alcohol to clean the tubes. Soften any solid incrustations and remove them using e.g. TRACOE tube clean cleaning swabs (REF 935 and REF 936). After cleaning, rinse the cannulas thoroughly. Allow the inner and outer cannulas to air-dry.



Please note:

The tips and instructions for the care of the tracheostoma and tracheal hygiene are based on the manufacturer's practical experience. They are not intended to replace the medical advice of a physician or trained healthcare personnel.

TRACOE medical GmbH assumes no liability for claims resulting from the incorrect or improper care of the tracheostoma or incorrect or improper tracheal hygiene.

Medical indications as well as anatomical and physiological conditions vary for each tube wearer. For this reason, patients must consult their physician or healthcare professional for advice on the care of the tracheostoma and tracheal hygiene. Instructions given by the physician and healthcare personnel must be followed.

Disinfection

If necessary, clean the tubes and then soak them in a disinfectant recommended by TRACOE medical. Afterwards rinse the tubes thoroughly in running water or with distilled water.

Hygiene

When the tracheostoma is stable, the tubes can be cleaned and maintained during replacement. If the tracheostoma is fresh, however, do not remove the tube for very long, as it may be very difficult to reinsert. Please note that the tube must be taken out of the tracheostoma for cleaning.

Care of the stoma depends on mucous accumulation, scab formation, and skin condition, but it should be cleaned at least twice a day. Use either the TRACOE protective skin cloth (REF 970) or fleece compresses saturated with physiological saline solution to clean the stoma. Do only use fluff free material. Replace the compresses and neck straps regularly. Select the widest, softest neck strap possible to prevent irritation. The skin should be clean and dry (neither desiccated nor waterlogged). If the area around the tracheostoma is chafed, the skin can be treated with appropriate care products according to doctor's orders. When the irritation disappears, treat the area with a skin dressing that is not excessively viscous. A vaporized 0.9% saline solution can be inhaled to loosen or remove scabs or incrustations. A tracheostoma being treated with radiation is often highly sensitive and should be cared for as instructed by your physician or healthcare personnel.

Protective Accessories

To prevent particles of dust and dirt or other objects from entering the trachea through the stoma, special protective articles are needed such as cloths, bibs, roll-necks, filters, etc. Depending on personal requirements, each patient should have at least six such articles on hand.

Suctioning Frequency

In the same patient the necessity to suction can vary from just a few times each day to up to a number of times an hour. It is important to use a high-quality suction device with suitable performance.

Moistening

To prevent the formation of scab, the use of an “artificial nose” (e.g. TRACOE humid assist I, REF 640-CT) to keep the airways moist is recommended. Another method is to inhale a vaporized saline solution. A room with up to 50 or 60% relative humidity also helps to maintain proper moisture levels in the airways.

Materials

TRACOE tracheostomy tubes are made of materials that are approved internationally for medical use. They contain no latex. These products may only be disposed of in compliance with the applicable local regulations for waste materials. In the United States, federal law stipulates that these products may only be sold by or when prescribed by physicians.

INFORMATION FOR DISTRIBUTORS

Sales Support

TRACOE medical provides authorized distributors with valuable support for advising their patients:

Tube Info Card

Every TRACOE tube and most of the larynx products come with a card containing all relevant data for documentation and re-ordering purposes in the form of peel-off stickers on the front and back.

Advertising

Photographs of all TRACOE products are available for use in advertising or to create your own training documents; please specify the desired file format.

Sales Forces

TRACOE product specialists are available to support you in dealing with difficult indications and training your sales force.

Training

TRACOE medical conducts training sessions on products and their applications on request.

News-Service

You receive current information many times throughout the year.

Trade Shows/Conferences

TRACOE medical participates in many major national and international trade shows and conferences. TRACOE medical can also provide you with product posters and catalogues to use at your own events.

Basic Kit

TRACOE partners have found the top quality TRACOE demonstration case to be an excellent way to display the products. The demonstration cases can be individually stocked with TRACOE products and offer an excellent overview of the TRACOE portfolio at presentations.



ORDERING

Delivery

All TRACOE products are shipped directly ex stock. Non-sterile product variants are generally shipped within 10 days, sterile ones within 4 weeks. Please note: Additional freight charges apply in cases of express deliveries and deliveries to addresses which differ from the address on the invoice.

Returns

Returns of used products are accepted only if accompanied by a completed decontamination certificate. You can obtain the required form either directly from TRACOE medical or from their website (www.tracoe.com).

General Terms and Conditions of Business:

Sales and deliveries are made only on the basis of the general terms and conditions of business. You can obtain these either directly from TRACOE medical or from their website (www.tracoe.com).

telephone: +49-69-665668-99
+49-69-665668-86

fax: +49-69-665668-20

e-mail: info@tracoe.com



To ensure prompt handling of your order please indicate the exact reference numbers (REF), the sizes of the tubes and your customer number on your order form.



Internet

To quickly and conveniently obtain information about TRACOE products, news, or general information, simply visit the Internet at: www.tracoe.com.



TRACOE medical GmbH
 Reichsforststr. 32, 60528 Frankfurt/Main, Germany
 Tel. +49-69-665668-0, Fax +49-69-665668-10
www.tracoe.com, E-Mail: info@tracoe.com

Subject to changes without notice 5.0

