



**SET-0508/SET-0504**

**Single use Smoke Evacuation Sets**

*Fits all electro-surgical pencils*

*- both single use and reusable pencils.*

*Shown here with LiNA 508 reusable pencil.*

**SET-0120**

**Reusable Smoke Evacuation Attachment**

**Autoclavable 5-10 times.**

**Separate tubing.**

*Fits most electro-surgical pencils*

*- both single use and reusable pencils.*

*Shown here with LiNA 508 reusable pencil.*

# LiNA Smoke Evacuation Tubing Sets

*Reusable and Single Use Attachments  
for Electrosurgery Pencils*

*For smoke evacuation during monopolar  
electrosurgical procedures.*



*Both the reusable and the single use pencil attachments are available with either 22mmØ connector for smoke evacuators or 6-8mmØ connector for central vacuum systems.*

## LiNA Smoke Evacuation Tubing Sets

Reusable and single use attachments for electrosurgery pencils. For smoke evacuation during monopolar electrosurgical procedures. The tubing sets fit most electrosurgical pencils and are available with either a 6-8 mmØ tubing connector for connection to central vacuum systems or with a 22mmØ connector with liquid trap for smoke evacuators. The LiNA Tubing Sets can be connected to all smoke evacuation systems as well as central vacuum systems.

For information on the LiNA Smoke Evacuation System, see separate leaflet.

### LiNA Smoke Evacuation Trolley

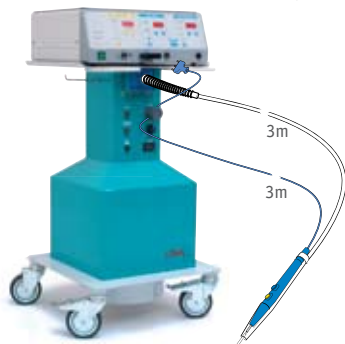

**SET-0508**  
**Smoke Evacuation Tubing Set.**  
Single use pencil attachment with 3m tubing and 22mmØ connector for smoke evacuators.

### LiNA Smoke Evacuation Desk Top

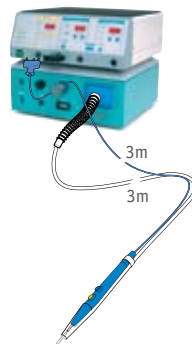

**SET-0504**  
**Smoke Evacuation Tubing Set.**  
Single use pencil attachment with 3m tubing and 6-8mmØ connector for collecting bottles.

### All central vacuum systems

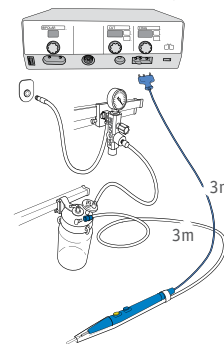

**SET-0120**  
**Reusable silicone smoke evacuation pencil attachment.**  
Autoclavable 5-10 times.

For use with either:  
**SET-0122 Separate single use tubing.**  
With 22mmØ connector for smoke evacuators.

Or for use with:  
**SET-0124 Separate single use tubing.**  
With 6-8mmØ connector for collecting bottles.

### Ordering Information:

### LiNA Smoke Evacuation Tubing Sets 0459

REF.	Product	Packing
SET-0508	<b>LiNA Smoke Evacuation Tubing Set - Single use</b> - 3m tubing with a liquid trap and <b>22mmØ connector</b> for LiNA, Erbe, Conmed, Stackhouse, Buffalo, Atmos, Finesse and Aaron smoke evacuators.	Box of 10 sterile
SET-0504	<b>LiNA Smoke Evacuation Tubing Set - Single use</b> - 3m tubing with <b>6-8mmØ connector</b> for collecting bottle systems or Valleylab smoke evacuators.	Box of 10 sterile
SEG-0500	<b>LiNA Extension Tubing - Single use</b> - 6cm for SET-0508, for long electrodes.	Box of 10 sterile
SET-0120	<b>LiNA Silicone Smoke Evacuation Attachments - Reusable</b> - Autoclavable 5-10 times.	Box of 10 sterile
SET-0122	<b>LiNA Smoke Evacuation Tubing - Single use</b> - for use with SET-0120 pencil attachment. 3m tubing with a liquid trap and <b>22mmØ connector</b> for LiNA, Erbe, Conmed, Stackhouse, Buffalo, Atmos finesse and Aaron smoke evacuators.	Box of 10 sterile
SET-0124	<b>LiNA Smoke Evacuation Tubing - Single use</b> - for use with SET-0120 pencil attachment. 3m tubing with <b>6-8mmØ connector</b> for collecting bottle systems or Valleylab smoke evacuators.	Box of 10 sterile
SEG-0100	<b>LiNA Extension Tubing - Single use</b> - 6 cm for SET-0120, for long electrodes.	Box of 10 sterile

