



Innovation in Gynecology

## LiNA Blood Sampler™

Fast and easy collection of  
blood samples during delivery

The LiNA Blood Sampler is a unique device that enables collection of blood samples from the fetal scalp, in order to perform a quick analysis of vital blood parameters.

# LiNA Blood Sampler™

## Safe

Sterile, ready for use

- Safe collection of blood from the fetal scalp during delivery

The instrument is delivered sterile and ready for use.



## Versatile

Built-in light source

- All in one instrument

The instrument consists of a retractable scalpel and a capillary tube holder.

It is possible to connect a light cable to the LiNA Blood Sampler to offer the physician perfect illumination of the fetal scalp throughout the procedure.



## Functional

5-step procedure

1. Prepare and fit an appropriate capillary tube for receiving the blood sample
2. Push knife forward to penetrate skin, to draw blood
3. Retract knife, sample blood with capillary tube
4. Insert capillary tube into blood analyser.
5. For more tests, change capillary tubes

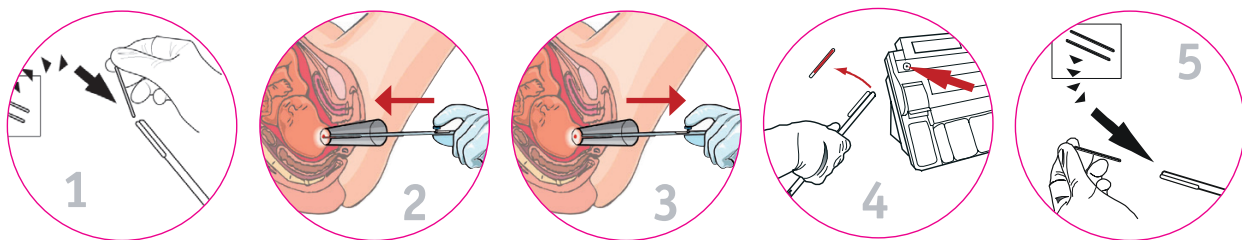

### Ordering information:

### LiNA Blood Sampler™

REF.	Product	Packing
4301	LiNA Blood Sampler – Fetal Scalp Blood Sampler. Single Use.	Box of 10, sterile
4210-S	LiNA Light Cable – Light cable to connect the blood sampler to a light source, Storz connector. Reusable.	Box of 5
4210-B	LiNA Light Cable – Light cable to connect the blood sampler to a light source, BSI/ACMI connector. Reusable.	Box of 5
4210-W	LiNA Light Cable – Light cable to connect the blood sampler to a light source, Richard Wolf connector. Reusable.	Box of 5